

Short installation guide

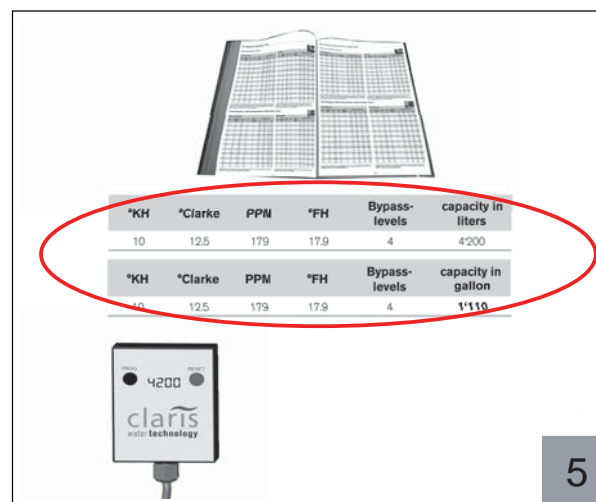

Combi Steamers / Self-Cooking Systems / Steam Cookers / Ovens

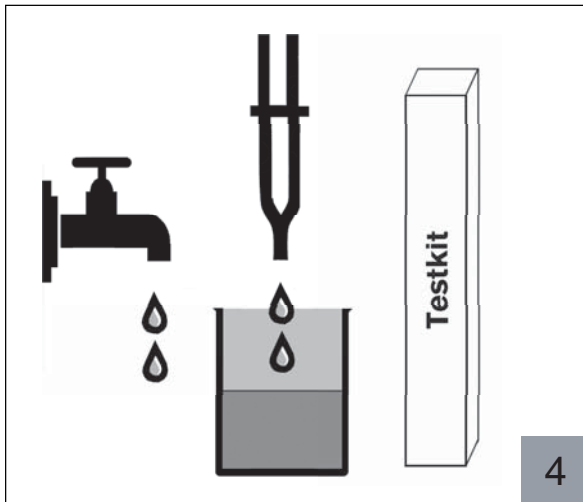
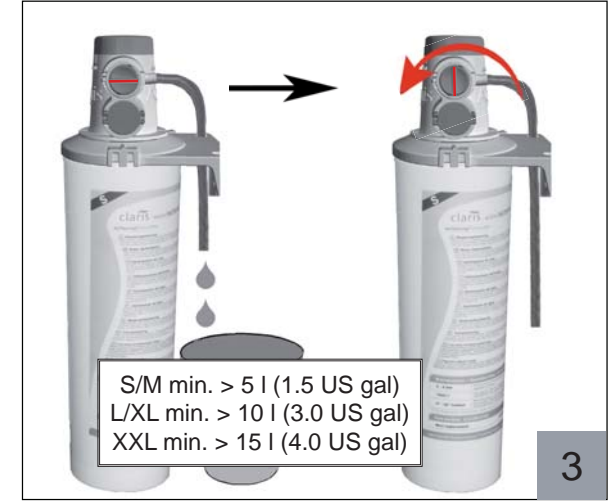
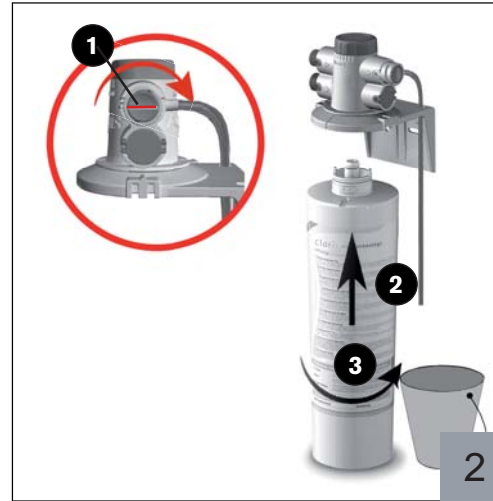
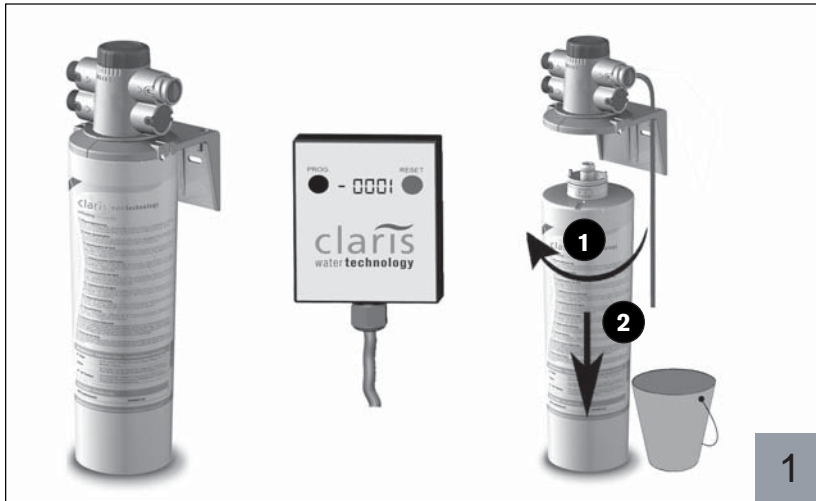

Direct Injection									
°KH	Grains (US)	PPM	°FH	By-pass-levels	capacity in US gal				
					S	M	L	XL	XXL
< 6	6	107	11	0	400	660	1'230	1'760	2'910
7	7	125	13	0	340	560	1'060	1'510	2'490
8	8	143	14	0	300	500	930	1'320	2'180
9	9	161	16	0	260	440	820	1'170	1'940
10	10	179	18	0	240	400	740	1'060	1'740
11	11	196	20	0	220	360	670	960	1'580
12	12	214	21	0	200	330	620	880	1'450
13	14	232	23	0	180	300	570	810	1'340
14	15	250	25	0	170	280	530	760	1'240
15	16	268	27	0	160	260	490	700	1'160
16	17	286	29	0	150	250	460	660	1'090
17	18	304	30	0	140	230	440	620	1'020
19	20	339	34	0	120	210	390	560	920
21	22	375	38	0	110	190	350	500	830
23	24	411	41	0	100	170	320	460	760
26	27	464	46	0	90	150	280	410	670
29	30	518	52	0	80	140	250	370	600
33	34	589	59	0	70	120	230	320	530
38	40	679	68	0	60	100	190	280	460

Capacities are intended as guidelines and can vary according the machine typ. Please contact us for recommendations.

Boiler System									
°KH	Grains (US)	PPM	°FH	By-pass-levels	capacity in US gal				
					S	M	L	XL	XXL
< 6	6	107	11	3	570	940	1'760	2'520	4'150
7	7	125	13	3	490	810	1'510	2'160	3'560
8	8	143	14	2	370	620	1'160	1'650	2'720
9	9	161	16	2	330	550	1'030	1'470	2'420
10	10	179	18	2	300	500	930	1'320	2'180
11	11	196	20	2	270	450	840	1'200	1'980
12	12	214	21	2	250	410	770	1'100	1'810
13	14	232	23	2	230	380	710	1'020	1'680
14	15	250	25	2	210	350	660	940	1'560
15	16	268	27	2	200	330	620	880	1'450
16	17	286	29	2	190	310	580	820	1'360
17	18	304	30	2	170	290	540	780	1'280
19	20	339	34	2	160	260	490	700	1'150
21	22	375	38	1	130	210	390	560	920
23	24	411	41	1	110	190	360	510	840
26	27	464	46	1	100	170	320	450	740
29	30	518	52	1	90	150	280	400	670
33	34	589	59	1	80	140	250	350	590
38	40	679	68	1	70	120	220	310	510

Capacities are intended as guidelines and can vary according the machine typ. Please contact us for recommendations.