

**FAUCET KITS**

SPK:- SINGLE PANTRY DPK:- DOUBLE PANTRY

WHERE USED	FAUCET KIT	REV.	ITEM #1 SPOUT 1 REQUIRED	ITEM #2 FAUCET BODY 1 REQUIRED	ITEMS #3,8,9,10 BRACKET KIT 1 REQUIRED	ITEM #4 "C" CLIP 1 REQUIRED	ITEM #5 "O" RING 1 REQUIRED	ITEM #6 FAUCET NUT 1 REQUIRED	ITEM #7 ADAPTOR WASHER 1 REQUIRED	ITEM #12 CARTON 1 REQUIRED	ITEM #15 FAUCET SPOUT FITTING 1 REQUIRED	ITEM #16 LOCKNUT 3/4 NPS 1 REQUIRED	ITEM #17 FLANGED NUT (C/PLTD)3/4 NPS 1 REQUIRED	REVISION COMMENTS
KDT-12/20-T (MOUNTED ON SD OR ST)	SPK1 DPK1	C C	KE50825-1	KE51401 KE51403	NA				KE50335 NA					
KDL-60/80/100-T, KEL-40/60/80/100-T	SPK2 DPK2	E E	KE50825-2	KE51401 KE51403	FBKT				KE50335 NA		NA	NA	NA	SEPARATE KEL-40/60/80/100-T INTO A NEW ROW
KGT-6/12-T, MKET-12/20-T, KDP60-100/80T	SPK3 DPK3	G G	KE50825-3	KE51401 KE51403	FBKT				KE50335 NA					SEPARATE KEL-25-T INTO A NEW ROW
KDL-25/40-T, KEL-25-T, KDP-25 & 40-T	SPK3 DPK3	G G	KE50825-3	KE51401 KE51403	FBKT				KE50335 NA					
WM (WATER METER)	N/A	D	KE50825-4	NA	NA				NA		KE51585	SD50098	SD50097	
ALL STATIONARY KETTLES EXCEPT HA-MKGL	SPK5 DPK5	D D	KE50825-5	KE51401 KE51403	NA				KE50335 NA					
KDM-25/40, KDM-25/40-T	SPK6 DPK6	E E	KE50825-6	KE51401 KE51403	NA				KE50335 NA					
KDL-40/60/80-TSH & KEL-40/60-TSH	SPK7 DPK7	D D	KE50825-7	KE51401 KE51403	FBKT				KE50335 NA					
KDT-6-T (MOUNTED ON SD & ST STAND)	SPK8 DPK8	E E	KE50825-8	KE51401 KE51403	NA	FA95007-10	FA05002-19	KE51736	KE50335 NA	PA95041				
TKET-3/6/12-T, KET-3/6/12-T	SPK9 DPK9	D D	KE50825-9	KE51401 KE51403	FBKT				KE50335 NA					
KDL-125/150-T, KGL-40/60/80-T, KGL-40-TSH	SPK10 DPK10	B B	KE50825-10	KE51401 KE51403	FBKT				KE50335 NA		NA	NA	NA	
HA-MKGL-60/80/100-T	SPK11 DPK11	B B	KE50825-11	KE51401 KE51403	FBKT				KE50335 NA					
SEL/SGL-T1/KGL-25-T	SPK13 DPK13	B B	KE50825-7	KE51401 KE51403	FBS-T1 OR FBKGL25T				KE50335 NA					
SEL/SGL-TR	SPK14 DPK14	B B	KE50825-6	KE51401 KE51403	FBS-TR				KE50335 NA					
SET-10	SPK15 DPK15	A A	KE50825-6	KE51401 KE51403	FBS-SET10T				KE50335 NA					
SET-15	SPK16 DPK16	A A	KE50825-6	KE51401 KE51403	FBS-SET15T				KE50335 NA					
HA-MKGL-60/80/100	SPK17 DPK17	A A	KE50825-12	KE51401 KE51403	NA				KE50335 NA					
KDM-60-T	SPK18 DPK18	A A	KE50825-2	KE51401 KE51403	NA				KE50335 NA					
TKET-3/6/12-T, KET-3/6/12-T	SPK19 DPK19	A A	KE50825-9	KE51401 KE51403	FBKT-1				KE50335 NA					ADD SPK19, DPK19 & FBKT-1
KEL-40/60/80/100-T, KGT-6/12-T	SPK20 DPK20	A A	KE50825-2	KE51401 KE51403	FBKT-1				KE50335 NA					ADD SPK20, DPK20 & FBKT-1
KEL-25-T	SPK21 DPK21	A A	KE50825-3	KE51401 KE51403	FBKT-1				KE50335 NA					ADD SPK21, DPK21 & FBKT-1
KGL-25/40/60/80-T, KGL-40-TSH	SPK22 DPK22	A A	KE50825-10	KE51401 KE51403	FBKT-1				KE50335 NA					ADD SPK22, DPK22 & FBKT-1

#	DESCRIPTION	DATE	APPROVED
T	REFER TO REVISION COMMENTS	07/23/2018	KHUANG
T	REFER TO REVISION COMMENTS PICTORIAL UPDATE, ADDED ITEM # 15	07/25/2018	FGUIRGUIS

**PACKAGING INSTRUCTIONS**

1. REFERRING TO BILL OF MATERIAL AND GATHER ALL REQUIRED PARTS.
2. ASSEMBLE NUT (item 6), RETAINING RING (item 4) AND "O" RING (item 5) ONTO SPOUT.
3. IF KIT HAS A FAUCET BRACKET, ADD BOLTS (item 8), LOCK WASHERS (item 10) AND NUTS (item 9) TO BRACKET (item 3). WRAP IN PLASTIC.
4. PLACE PARTS IN CARTON AND LABEL CARTON WITH PART NUMBER (i.e.; SPK1,2,3 ETC.).

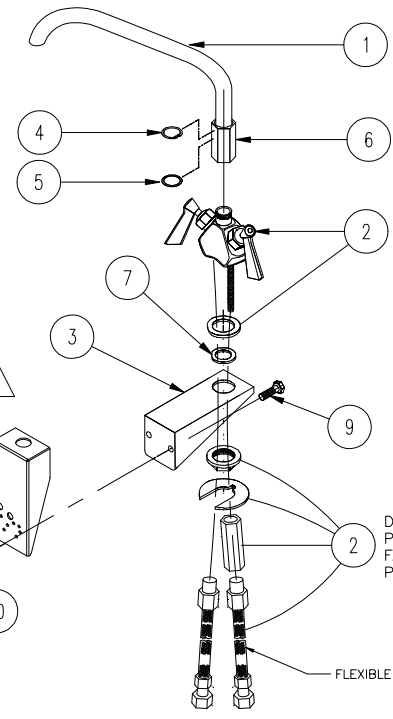

DETAIL A  
(DOUBLE PANTRY FAUCET MTG DETAIL)

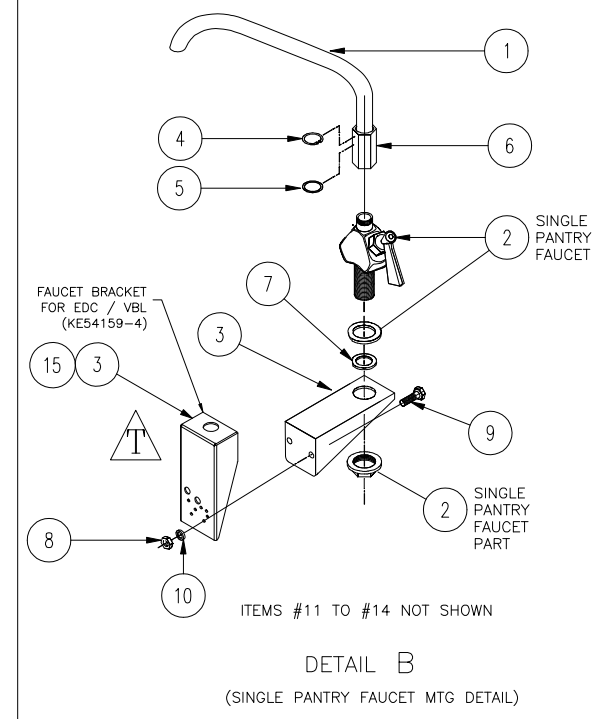

DETAIL B  
(SINGLE PANTRY FAUCET MTG DETAIL)

**FAUCET BRACKET KITS**

WHERE USED	FAUCET KIT	REV.	ITEM #3 BRACKET 1 REQUIRED	ITEM #8 NUT 2 REQUIRED	ITEM #9 BOLT 2 REQUIRED	ITEM #10 LOCK WASHER 2 REQUIRED	ITEM #11 SPACER PLATE 1 REQUIRED	ITEM #13 HOLE JIG 1 REQUIRED	ITEM #14 INSTRUCTIONS 1 REQUIRED	ITEM #15 FAUCET LABEL 1 REQUIRED	REVISION COMMENTS
KETTLES "KET, KELT, KGL-25/40/60/80-T, KGL-40-TSH, KGT-6/12-T", STANDARD FAUCET BRACKET	FBKT-1	A	SK00395-3		FA11258		NA	NA	NA	KE603996-5	
ALL TILTING KETTLES EXCEPT "KET, KGT, KGLT & KELT", STANDARD FAUCET BRACKET	FBKT	D	KE54159		FA11258		NA	NA	NA	NA	WAS ALL TILTING KETTLES
KETTLES "KET, KGT, KGLT & KELT", CORRECTIONAL PACKAGE FAUCET BRACKET	CP-FBKT-1	A	KE02071-3		NA		NA	NA	NA	KE603996-5	
ALL TILTING KETTLES EXCEPT "KET, KGT, KGLT & KELT", CORRECTIONAL PACKAGE FAUCET BRACKET	CP-FBKT	F	KE02071-1		NA		NA	NA	NA	NA	WAS ALL TILTING KETTLES
SKILLETS "T1", STANDARD FAUCET BRACKET	FBS-T1	F	SK00395-1	FA21008	FA11258	FA31029	NA	NA	NA	KE603996-5	
KGL-25-T, CORRECTIONAL PACKAGE FAUCET BRACKET	CP-FBKGL25T	A	KE02071-2		NA		KE54862-5	NA	NA	NA	OBSOLETE
TILTING KETTLES, FRENCH FAUCET BRACKET	FBKT-F	C	KE54159-3		NA		NA	NA	NA	NA	OBSOLETE
SKILLETS "T1", FRENCH FAUCET BRACKET	FBS-F-T1	D	SK00395-2		FA11258		NA	NA	NA	NA	OBSOLETE
SKILLETS "TR", STANDARD FAUCET BRACKET	FBS-TR	E	SK2382300		FA11258		SK2382400	SK2382500	SK2925	NA	
SKILLETS "SET-10-T", STANDARD FAUCET BRACKET	FBS-SET10T	A	SK2308800		FA11260		NA	NA	NA	NA	
SKILLETS "SET-15-T", STANDARD FAUCET BRACKET	FBS-SET15T	A	SK2302200		NA		NA	NA	NA	NA	
SKILLETS T1, CORRECTIONAL PACKAGE FAUCET BRACKET	CP-FBS-T1	B	KE02071-2		NA		KE54862-5	NA	NA	KE603996-5	
KGL-25-T, STANDARD FAUCET BRACKET	FBKGL25T	A	SK00395-1		FA11258		NA	NA	NA	NA	OBSOLETE

THIS DESIGN COVERS A PROPRIETARY ITEM AND IS THE PROPERTY OF CLEVELAND RANGE LTD.  
THIS DRAWING IS NOT TO BE COPIED OR USED WITHOUT THE APPROVAL OF CLEVELAND RANGE LTD.

FOR GENERAL TOLERANCES REFER TO PWI-043

**CLEVELAND RANGE LTD.**  
8251 KEELE STREET, CONCORD, ONTARIO, CANADA

TITLE  
**KITS; FAUCET & BRACKET  
DPK, SPK, FBS, FBK**

MATERIAL  
TYPE & GRADE  
FORM  
SIZE  
FINISH

DO NOT SCALE  
PRINTED DRAWING

DRAWN BY

DATE  
**2/28/2007**

SIZE  
**B**

DRAWING NO.

**KE95491**

SHEET 1 OF 1

REV  
**T**