

NOTES:

1. CHANNEL SUPPORT SHOWN (P/N 69966) IS USED ON 600MM BASE. CHANNEL SUPPORT NOT SHOWN (P/N 69967) IS USED ON 900 AND 1050MM BASES.

2. WIRE CORROSION ANODE (ITEM 31) AND TAG (ITEM 32) TO STAY ROD INSIDE OF BOILER.

PLACE BAFFLES ACROSS RODS ON INSIDE OF GENERATOR IN CONFIGURATION SHOWN

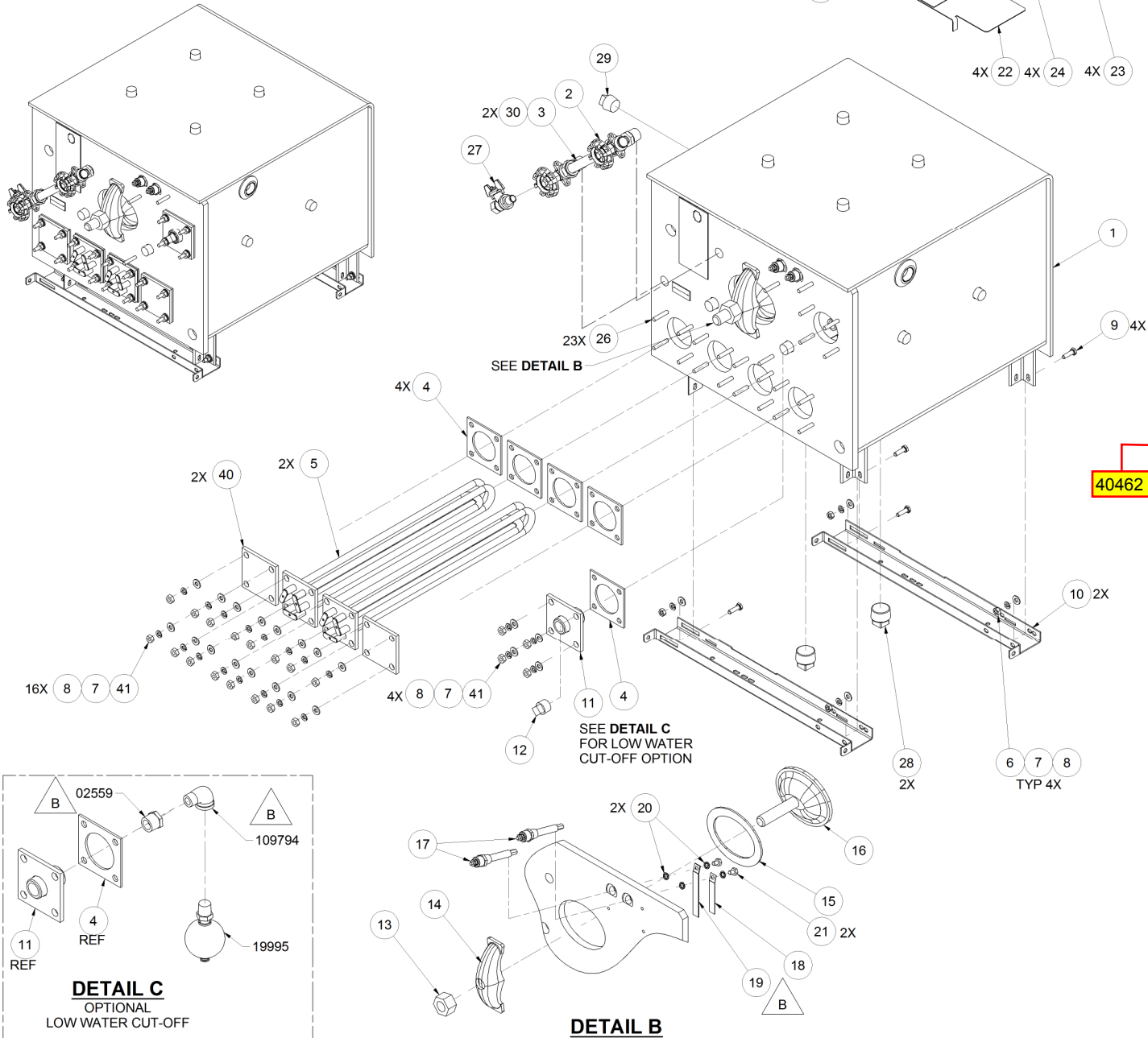

LET.	DESCRIPTION	DATE	BY
A	PRODUCTION RELEASE PER ECR-11-004	01-17-11	MMM
B	1) P/N 02559 WAS 02623, 2) P/N 109794 WAS 05253,	02/02/2012	RCB
-	3) SWITCHED ITEMS 18 & 19 LOCATION, PER ECR-11-347	-	-

New Electric Boiler
After 1-23-2012

* = NOT SHOWN

41	20	100285	NUT, HEAVY DUTY HEX, 1/4-20 SST
40	2	16546	PLATE, BLOCKOFF LWCO/HEATER HOLE
33	A/R	00934	SEALANT
32	1	14885	LABEL, CORROSION ANODE TAG
31	1	0408	CASTING, CORROSION ANODE, ASSEMBLY
30	2	07108	FIBER WASHER
29	1	16608	PLUG, SQ HD, 3/4 PIPE, BLACK
28	2	16637	PIPE, PLUG, 1-11-1/2 NPT, MALLEABLE IRON, SQ. HD.
27	1	03276	VALVE, BALL, 1/4 BRASS MALE-FEMALE, FULL PORT
26	23	112051	STUD, SST, 1/4-20 X 1-1/2
25	4	16328	PIN, COTTER, 1/16 X 1, BRASS
24	1	52165	KEEPER; BAFFLE; ELECTRIC BOILERS
23	1	102364	BAFFLE; CENTER; ELECTRIC GENERATOR
22	1	110967	KEEPR; BAFFLE; ELECTRIC BOILERS
21	2	19218	SCREW, 1/4-20 X 3/8, HEX HEAD, SST
20	4	23151	WASHER, INTERNAL TOOTH LOCK, 1/4
19	1	110966	EXTENSION, WATER PROBE, 3.500; STEAM GENERATOR
18	1	62452	EXTENSION, WATER PROBE, .500X2.500; 20GA; SST
17	2	46674	PROBE, LIQUID LEVEL
16	1	100329	COVER, HANDHOLE
15	1	100330	GASKET, HANDHOLE
14	1	100332	YOKE, 3 X 4 HANDHOLE GENERATOR
13	1	100333	NUT, HEX - HEAVY 3/4-10 UNC 2B
12	1	16602	Square Head Plug
11	1	41943	PLATE, MOUNTING - WELDMENT LOW WATER CUT - OFF
10	2	69966	SUPPORT, GENERATOR MTG. FOR S/S ANGLE BASE - 600 MM
9	4	19288	SCREW, 1/4-20 X 3/4, HEX, HD, ZINC PLATED
8	24	23116	WASHER, FLAT, 281 ID x.625 OD x .065 THK, SST
7	24	23105	WASHER, LOCK, 1/4" KATLINK STYLE, SST
6	4	14610	NUT, HEX, 1/4-20, STAINLESS STEEL
*	-	08215	X,HEATER,1PH,12KW,250V, 3 IN SQ FLANGE
*	-	08214	X,HEATER,1PH,12KW,208/220, 3"SQ FLANGE
*	-	08197	HTER;STARWOUND;3PHASE;4 WIRE STAR&Y;12KW/220/380
*	-	08167	X,HEATER,3PH,12KW,440/480, 3"SQ FLANGE
*	-	08166	X,HEATER,3PH,12KW,230/240V, 3"SQ FLANGE
*	-	08163	HEATER;3 PH;12KW 600V 3 IN SQ FLANGE
*	-	08155	HEATER;3PH STARWIRE;3IN SQ FLANGE;12KW416/240V
5	2	08165	X,HEATER,3PH,12KW,208/220V,3"SQ FLANGE
4	5	07128	GASKET, HEATER
3	1	07302	GAUGE, WATER, 5/8 x 6.000",GLASS, PYREX RED LINE
2	1	07176	1/2 GAUGE, SET WATER (COMP.) PLAIN
1	1	109913	WELDMENT, 2 PROBE ELECTRIC BOILER

CLEVELAND RANGE, LLC
1333 East 179th St., Cleveland, Ohio 44110-2574

THIS DESIGN DESCRIBES A PROPRIETARY ITEM AND IS THE PROPERTY OF CLEVELAND RANGE. THIS DRAWING IS NOT TO BE COPIED OR USED WITHOUT THE APPROVAL OF CLEVELAND RANGE.

TOLERANCES (UNLESS OTHERWISE NOTED)	DO NOT SCALE PRINTED DRAWING	DRAWN BY M. MILLIGAN	DATE 1/19/2011
DECIMAL ± 0.030	TITLE ELECTRIC BOILER ASSEMBLY 2 PROBE, 2 HEATER		
ANGULAR ± 1°	SIZE C	DRAWING NO. 260BFL	SHEET 1 OF 1 REV B

NOTE:
THIS DRAWING REFLECTS MOST COMMON
CONFIGURATION OF ELECTRIC BOX.

REFER TO BILL OF MATERIALS AND WIRING
DIAGRAM FOR CONFIGURATIONS NOT SHOWN.

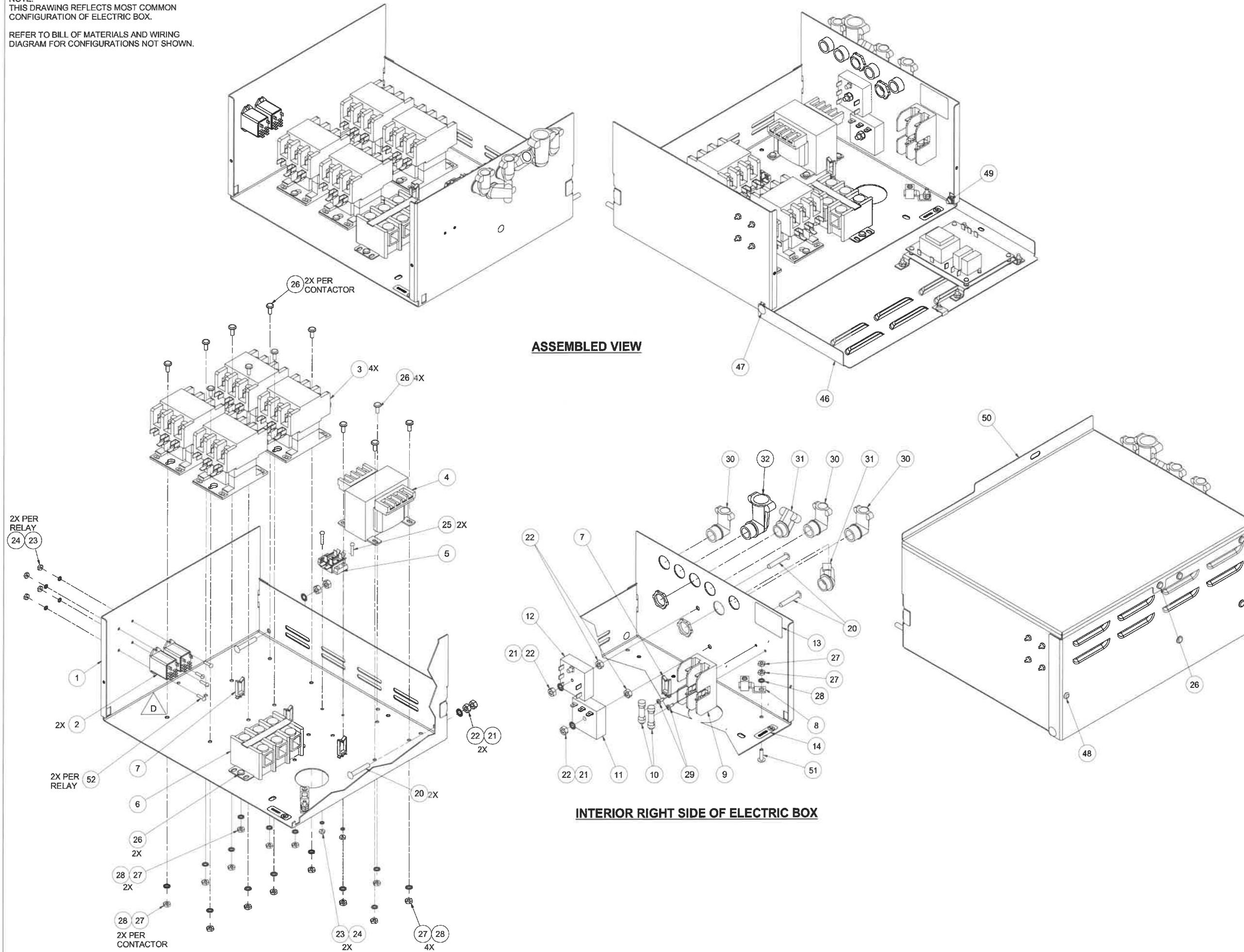

LET.	DESCRIPTION	DATE	BY
A	PRODUCTION RELEASE PER ECR-11-004	01-25-2011	MM
B	ADDED ITEMS 46 - 50, REMOVED ITEMS 33 & 15, PER ECR-11-081	05-23-2011	MM
C	PICTORIAL UPDATE, PER ECR-11-415	01/16/2012	RCB
D	PAN 108612 - QTY 3 WAS 4, PER ECR-12-177	05/16/2012	RCB

ITEM	QTY	PART NO.	DESCRIPTION
* = NOT SHOWN			
52	4	19259	SCREW, RD HD, 6-32 X 1/2
51	1	109053	SCREW, 10-24 X 0.750 SST, PHILLIPS TRUSS HEAD
50	1	112056	COVER, BOX, COMPONENT, ELECTRIC BOILER
49	2	101873	NUT, HEX 1/4-20 THIN LOCK, ZINC PLTD. STEEL
48	2	106123	SCREW, 10-32 X 1/2, TORX/PAN HD, THRD FORMING, ZN
47	2	108644	SCREW, CARRIAGE, 1/4-20x1/2, SST (RND HEAD, SQ NECK)
46	1	113667	ASSEMBLY, COVER, FRONT, WATERBOARD, ELECTRIC BOILER
32	1	105247	CONNECTOR, GREENFIELD, 1/2, 90 DEG, SNAPITTE STYLE
31	2	105244	CONNECTOR, GREENFIELD, 3/8 IN; 45 DEG; LOCKNUT STYLE
30	3	105245	CONNECTOR, GREENFIELD, 3/8, 90 DEG, SNAPITTE STYLE
29	2	106126	SCREW, 8-32 X 1/2, TORX/SLT.PAN HD
28	15	23114	WASHER, LOCK, INTRNL TOOTH #10 TYPE A OR B, SST
27	16	14659	NUT, HEX, #10-24, SST
26	15	19287	SCREW, PAN HEAD 10-24 X .50" SST
25	2	19183	SCREW, RD HD, 6-32 X .75
24	6	23111	WASHER, LOCK, INTERNAL TOOTH, #6, ZINC PLTD
23	6	14674	NUT, HEX, 6-32, ZINC PLTD
22	8	14618	NUT, HEX, 1/4-20, STAINLESS STEEL
21	4	23137	WASHER, LOCK, INTERNAL TOOTH 1/4" SST
20	4	19265	SCREW, RD. HD. SST, 1/4-20 X 1-1/2 MACH.
14	1	14897	LABEL, GROUND
13	1	109986	LABEL, FUSE SIZE, 5 AMPS
12	1	300831	TIMER, 120 VAC, 60/90 HZ DELAY ON BREAK
11	1	20478	TIMER, SOLID STATE INTERV 3 MINUTE
10	2	109380	FUSE, 3.5 AMP
9	1	109374	BLOCK, FUSE, 2 POLE, 30 AMP
8	1	12331	LUG, GROUND, SOLDERLESS
7	3	108612	CLIP, WIRE, VERTICAL, 0.740" X 0.420"
-	1	02179	BLOCK-TERMINAL (4 TERMINAL)
-	1	02183	TERMINAL BLOCK HEAVY DUTY
6	1	02196	TERMINAL BLOCK-HEAVY DUTY
5	1	44168	TERMINAL, BLOCK ASM, 2 POLE
-	1	107040	TRANSFORMER, MULT-TAP; 240V480V PRIM., 150VA
-	1	20536	TRANSFORMER, 150VA, 240V480 PRIMARY, 120V SECONDARY
-	4	20535	TRANSFORMER, 150VA, 240V480V PRIMARY, 120V SECONDARY
-	-	03509	CONTACTOR, 50 AMP, 104-120V
3	4	03506	CONTACTOR, 3 POLE, 75 AMP
2	2	105966	RELAY, DPDT-W/MTC TABS
1	1	1120581	BOX, ELECTRIC BOILER

D
*
*
*
*
*

CLEVELAND RANGE, LLC			
1333 East 179th St., Cleveland, Ohio 44110-2574			
TOLERANCES UNLESS OTHERWISE NOTED			
DECIMAL	ANGULAR	DO NOT SCALE PRINTED DRAWING	DATE
± 0.030	± 1°	DRAWN BY M. MILLIGAN	1/21/2011
TITLE ELECTRIC BOX ASSEMBLY, ELECTRIC BOILER			
SIZE D	DRAWING NO. 260BFP	SHEET 1 OF 1	REV D