

NOTE:
 *1) CORRECT LENGTH TO BE DETERMINED.
 2) USE OF PIPE DOPE REQUIRED BUT NOT INDICATED ON DRAWING.

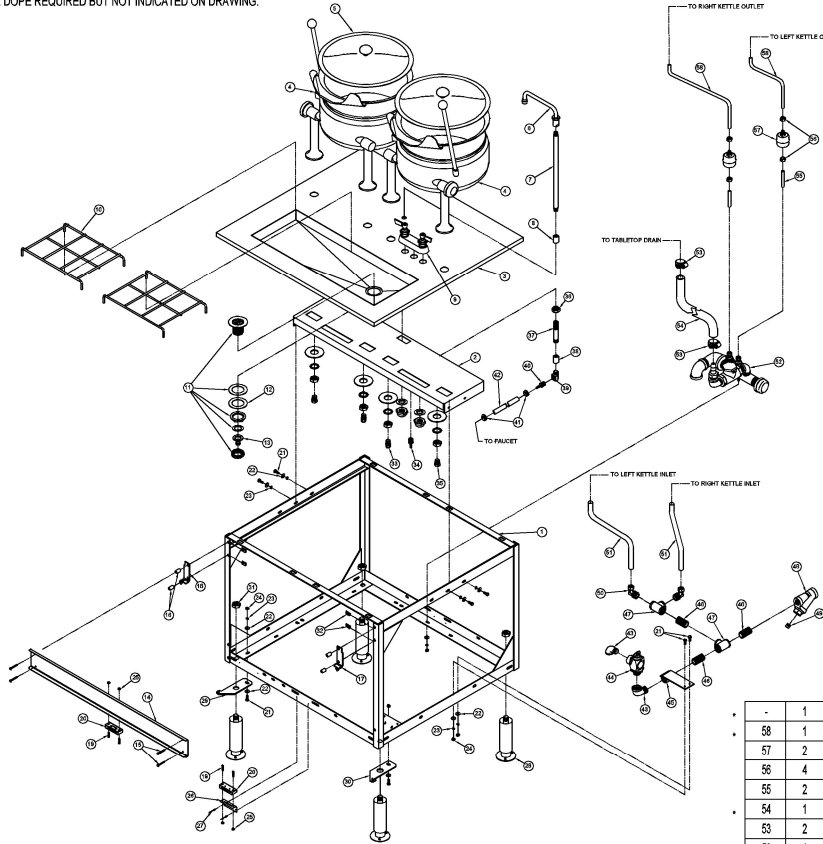

ITEM	QTY	PART NO.	DESCRIPTION
-	1	007282800	TUBE, COPPER, 1/4 x 28.000 (RIGHT KETTLE)
58	1	007282800	TUBE, COPPER, 1/4 x 28.000 (LEFT KETTLE)
57	2	20569	TRAP, THERMOSTATIC, 1/4
56	4	14681	NUT, COMPRESSION FTG., 1/4 TUBE
55	2	007280200	TUBE, COPPER, 1/4 x 2.000
54	1	085113000	HOSE, WHITE EPDM, 3/4 x 30.000
53	2	03204	CLAMP, WORM DRIVE, .812 - 1.500 DIA.
52	1	1068239	DRAIN MANIFOLD ASSEMBLY
-	1	007313500	TUBE, COPPER, 1/200 x 35.000 (3 GALLON)
-	1	007313000	TUBE, COPPER, 1/200 x 30.000 (3 GALLON)
-	1	007312500	TUBE, COPPER, 1/200 x 25.000 (3 GALLON)
51	1	007311900	TUBE, COPPER, 1/200 x 19.000 (3 GALLON)
50	2	06167	FITTING, COMPRESSION, 1/2T x 3/8MPT, 90DEG.
49	1	16601	PLUG, SO HD, 3/8, BLACK
48	1	19872	STRAINER, Y, 3/4 NPT
47	2	20205	TEE, 3/4, BLK
46	2	14343	NIPPLE, 3/4 x CLOSE, BLACK
45	1	100659	BRACKET, PTO MTG
44	1	SKE54941-2	VALVE, SAFETY, 3/4, 50 PSI
43	2	05259	ELBOW, STREET, 3/4, 90 DEG, BLK
42	1	1058501600	HOSE, NYLON REINFORCED, 1/4ID x 16.000
41	2	106526	CLAMP, WORM DRIVE, .25-.625 DIA
40	1	104382	FITTING, HOSE BARB, 1/4H x 3/8MPT
39	1	05280	ELBOW, STREET, 3/8, BRASS
38	1	03827	COUPLING, 3/8, BRASS
37	1	14428	NIPPLE, 3/8 x 4, THREAD PER DWG

ITEM	QTY	PART NO.	DESCRIPTION
36	1	14604	NUT, LOCK, 3/8NPT
35	2	06202	FITTING, COMPRESSION, 1/2T x 3/8MPT
34	1	104381	FITTING, HOSE BARB, 1/4H x 1/4MPT
33	2	06193	FITTING, COMPRESSION, 1/4T x 3/8MPT
32	4	108734	NUT, U TYPE (EXTRUDED), 10-24
31	4	14668	NUT, HEX, JAM, 3/4-10 ZINC PLTD
30	1	1020663	HINGE, LOWER RIGHT
29	1	1020662	HINGE, LOWER LEFT
28	4	06162	FOOT, ADJ., FLANGED
27	4	18366	RIVET, 1/8 DIA, FLUSH BREAK
26	2	532741	BRACKET, MAGNET MOUNTING
25	4	14674	NUT, HEX, 6-32, ZINC PLTD.
24	4	14618	NUT, HEX, 1/4-20 SST
23	8	23105	WASHER, LOCK, 1/4 SPLIT RING
22	9	23116	WASHER, FLAT, 1/4 x 5/8 x .065
21	7	19288	SCREW, HEX HD, 1/4-20 x 0.750
20	2	03100	CATCH, MAGNETIC
19	4	19206	SCREW, RD HEAD, 6-32 x 1.00 ZINC PLTD.
18	1	412812	HINGE, UPPER LEFT
17	4	412192	HINGE, UPPER RIGHT
16	4	19555	SPACER, 0.812 LG
15	4	106698	SCREW, TRUSS HD, PHILLIPS, 10-24 x 1.500
14	1	1051132	CONSOLE, 600MM, PLAIN
13	1	106736	TAIL PIECE, DRAIN
12	1	100728	WASHER, TROUGH DRAIN
11	1	105280	STRAINER, TABLETOP DRAIN
10	2	41409	RACK, DRAIN GRID, 10 INCH SQUARE
9	1	06125	FAUCET, MIXING, HOT & COLD, TABLETOP MOUNT
8	1	03966	COUPLING, FULL, 3/8, SST
7	1	144301	NIPPLE, 3/8 x 15 1/4, CHROME PLTD.
6	1	06107	SPOUT ASSY, W/ SWIVEL BODY, 8 INCH
-	2	CL-3	KETTLE LID, 3 GALLON
5	2	CL-6	KETTLE LID, 6 GALLON
-	1	SKDT3TLH316	KETTLE, 3 GALLON, 316 LINER
-	1	SKDT3TLH	KETTLE, 3 GALLON, 304 LINER
-	1	SKDT6TLH316	KETTLE, 6 GALLON, 316 LINER
-	1	SKDT6TLH	KETTLE, 6 GALLON, 304 LINER
-	1	SKDT3TRH316	KETTLE, 3 GALLON, 316 LINER
-	1	SKDT3TRH	KETTLE, 3 GALLON, 304 LINER
-	1	SKDT6TRH316	KETTLE, 6 GALLON, 316 LINER
-	1	SKDT6TRH	KETTLE, 6 GALLON, 304 LINER
-	1	109385	TABLETOP, K33
3	1	43138	TABLETOP, K66
2	1	101672	BRACE ASSY, KETTLE SUPPORT, 3/6 GALLON
-	1	1008822	BASE WELDMENT, 600MM, ALUM, CTD, DC
1	1	40872	BASE WELDMENT, 600MM, SST, DC

LET. REVISIONS DATE BY
 SEE SHEET 1 OF 2 FOR REVISIONS

CLEVELAND RANGE, LLC 1333 East 179th St., Cleveland, Ohio 44116-2574			
THIS DRAWING DESCRIBES A PROPRIETARY ITEM AND IS THE PROPERTY OF CLEVELAND RANGE. THIS DRAWING IS NOT TO BE COPIED OR REPRODUCED WITHOUT THE APPROVAL OF CLEVELAND RANGE.			
TOLERANCES (UNLESS OTHERWISE NOTED)	DO NOT SCALE	DRAWN BY	DATE
		EAG	07-08-94
DECIMAL	TITLE		
N/A	DOUBLE KETTLE ASSY (3/6 GALLON) 900MM BASE, DIRECT CONNECT		
ANGULAR	SIZE	DRAWING NO.	SHEET 2 OF 2
N/A	C	JKE0029	REV B