

SINGLE REMOTE MOUNTED CONTROLS FOR HORIZONTAL DIRECT STEAM MIXER KETTLES

Project _____
 Item _____
 Quantity _____
 FCSI Section 11400 _____
 Approved _____
 Date _____

Models

- Chart Recorder Controls
 Horizontal and Inclined Mixers
- HADECH
 - HADECHW (WALL MOUNT)



Model HADECH shown

Short Form Specifications

Models with Chart Recorder

Shall be Cleveland Model HADECH(W) , COOK CHILL CONTROL CENTER with individual controls for each mixer kettle; Solid State Temperature Controls with digital read-out; Two Time/Temperature Chart Recorders; Automatic and Manual Water Cooling; Simmer Controls; Automatic Water Meters with accumulative "add on" button and digital readout; Variable Mixer Speed Control and Mixer Start/Stop Button.

Standard Features

- Floor or wall mounting models (please specify)
- Individual controls for each kettle
- Variable mixer speed control
- Mixer start/stop
- Temperature control
- Controls for automatic and manual steam
- Controls for automatic and manual water cooling
- Simmer controls for delicate products
- Two (2) automatic water meters with accumulative "add on" button and digital readout (for cold water only)
- All stainless steel construction
- U.L. 508A Listed
- Accepted for use in U.S.D.A. Inspected Facilities

Models with Chart Recorder

- Time/Temperature Chart Recorder to provide permanent record of Batch Processing

Options & Accessories

- Lockable cover for controls for _____ CH models
- Dual water meter for hot and cold kettle fill
- Computer interface connections
- Computer interface terminals for hard wire connection
- 208/3/60; 240/3/60 and 460/3/60 voltages
- 380/3/50 or 575/3/60 export voltages

Model HA-DE-TS shown

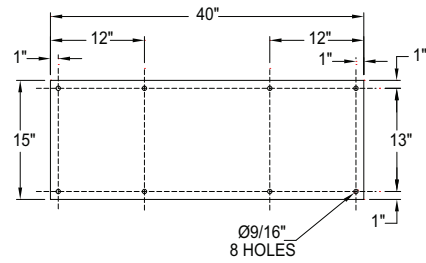

MINIMUM CLEARANCE	
FRONT	36"
SIDE	12"
REAR	0"

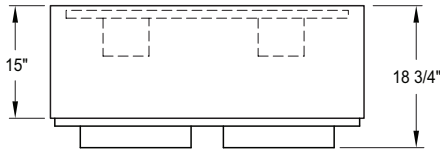

PLAN VIEW

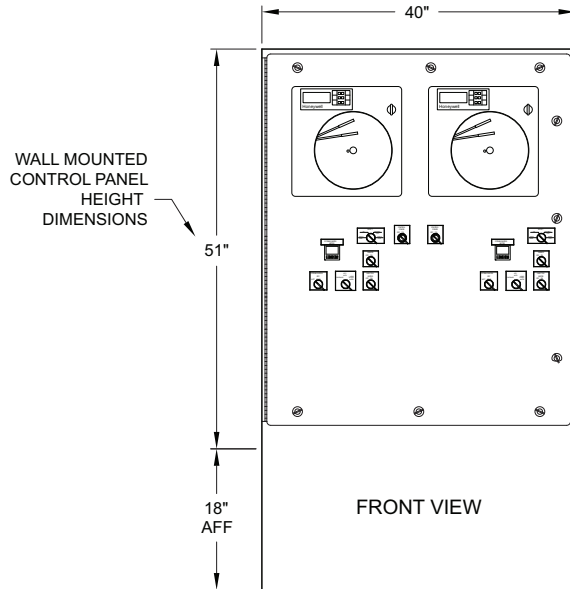

FRONT VIEW

Model	Description	Electrical 208V3PH/60HZ	Shipping Weight (Approximate)	Crate Size W x L x H
Floor Models				
HAECH	(Horizontal Mixers, Chart Recorder)	Amperage based on kettle size	800 lbs.	45" x 46" x 76"
Wall Mount Models:				
HASDECHW	(Horizontal Mixers, Chart Recorder)	Amperage based on kettle size	750 lbs.	61" x 31" x 33"

Notes:

The depth and width dimensions are the same for both the floor mount and wall mount panels.

Electrical power to and from control panel -

- Contractor must cut entry hole.
- Top or bottom power entry recommended.
- Must use proper connections to maintain U.L. listing.

Cleveland Range reserves right of design improvement or modification, as warranted.

(NOT TO SCALE)