

Installation Instructions

Field Installation of Door Steam Cutoff Switch and Magnet Repair Kit on Cleveland Steamers.

- The installation of this kit should only be performed by Welbilt KitchenCare authorized technicians. These technicians must be familiar with the features and construction of Cleveland steamers. This is a universal kit and can be used on all countertop, 10-Pan, and Classic Convection steamers.
- **THIS KIT PROVIDES PARTS TO REPAIR ONE CAVITY. A SECOND KIT WILL BE REQUIRED FOR UNITS WITH TWO CAVITIES IF BOTH NEED REPAIR.**
- Read the entire installation procedure before beginning.
- Questions? Contact Welbilt KitchenCare technical service at: 1-844-724-2273.

ITEMS INCLUDED IN KIT

Part Number	Description	Quantity
108879	MAGNET, DOOR STEAM CUTOFF	1
108880	SWITCH, DOOR STEAM CUTOFF	1
KE604150	SWITCH BRACKET, TABLETOP STEAMERS	1
KE604151	SWITCH BRACKET, 10 PAN, CLASSIC STEAMERS	1
KE003931	MAGNET BRACKET	1
KE604170	INSTRUCTION; REPAIR KIT, DOOR STEAM CUTOFF SWITCH AND MAGNET; ALL STEAMER MODELS	1
111592	CARRIAGE SCREW, #8-32 X ½, SST	4
101336	FLAT WASHER, #8, SST	4
109164	ACORN NUT, #8-32, SST	4
KE604172	SCREW, PHILLIPS TRUSS HEAD, #10-24 X 1, SST	1
104616	LOCKNUT, NYLON INSERT, #10-24, SST	1
14665	LOCKNUT, NYLON INSERT, 1/4-20, SST	1

Required Tools and Materials:

- No. 2 Phillips head screwdriver
- 5/16" nut driver, wrench, or socket with ratchet
- 3/8" nut driver, wrench, or socket with ratchet
- 7/16" nut driver, wrench, or socket with ratchet

- 6) Attach the magnet/bracket assembly to the outer door, in place of the original magnet.



- 7) Reinstall the inner door, if removed. Close the door and confirm proper door operation.



- 8) Remove the outer side panel that is on the same side of the unit as the control panel.

IF REPAIRING A THREE PAN GAS OR ELECTRIC “STEAMCHEF” STEAMER (I.E. 22CGT3.1 OR 22CET3.1), SKIP STEPS 11 AND 12, AND REPLACE THE SWITCH DIRECTLY, WITHOUT THE RELOCATION BRACKET. INTERFERENCE WITH THE WATER LEVEL PROBE PRECLUDES SWITCH RELOCATION WITH THE BRACKET.

- 11) Assemble the new switch from the kit to the bracket as shown using the #10 hardware in the kit. The bracket is specific for tabletop steamers, so use the one shown below.

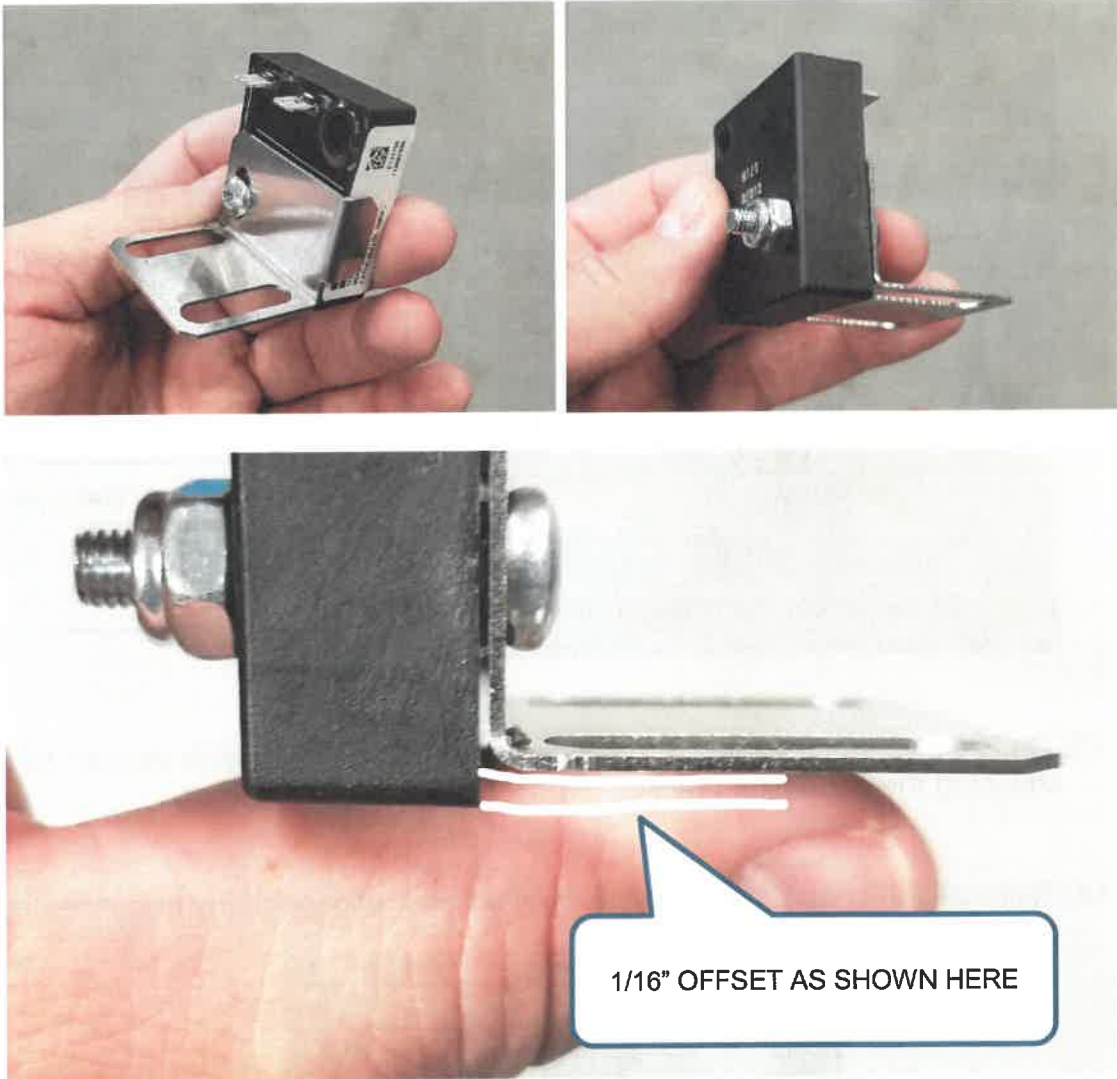

STEPS 15 THRU 17 COVER DOOR SWITCH REPAIR OF 10 PAN (GEMINI 24CGA10.2, 24CGA10.2ES, 24CGA10, 24CEA10, 24CGP10, 24CDP10), 6 PAN (24CGA6.2S, 24CGA6.2ES), AND 6 PAN CLASSIC CONVECTION (CGM, CKGM, CEM, CKEM, CSM, CDM, CKSM, CKDM) STEAMERS.

SKIP TO STEP 18 IF HAVING ALREADY PERFORMED STEPS 9 THRU 14 FOR REPAIRING TABLETOP STEAMERS.

- 15) Locate the door switch for the cavity to be repaired, then disconnect and remove it. Discard the switch, keep the hardware.



- 16) Assemble the new switch to the bracket as shown, using the #10 hardware. The bracket is specific for two-cavity steamers, so use the one shown below.



THIS SURFACE OF THE SWITCH SHOULD BE FLUSH WITH THE FLANGE ON THE BRACKET AS SHOWN.