



Claris Water Treatment System
for Convotherm by Cleveland Combi Ovens

System Components, Includes:

- one (1) Pre-filter
- one (1) Claris X-Large Steam System
- one (1) Claris Flow Meter
- one (1) Water Test Kit

Accessories:

- Claris X-Large Filter Cartridge (CWT-XLC)
- EC-110 Cartridge - Prefilter Replacement Cartridge (EC-110)

Cleveland Standard Features:

E-10 Prefilter System

- Filters out larger dirt and rust particles.
- Extends the life of primary filter cartridges.
- Tightly spun EC-110 sediment cartridge delivers 10 micron nominal filtration.
- Durable slim bowl design makes cartridge replacement easy.
- Clear housing allowing visual inspection of trapped particles to determine when to change the cartridge.
- 10" bowl design accepts most 10" drop in cartridges.

Claris Single Head with Zero Bypass

- Commercial quality filter head designed exclusively for Claris filter cartridges.
- Engineered for durability, strength and longevity.
- Corrosion resistant hardware.
- The system can be operated horizontally or vertically, depending on the available space.

Water Test Kit

- Used to determine the scale causing hardness (mainly calcium and magnesium).
- Indicates water test completion when the color changes from blue-green to orange-yellow.

MODEL: CWT-06 (includes complete system)



Short Form Specifications

Shall be Cleveland Model CWT-06 Claris Water Treatment System including one (1) Pre-filter, one (1) Claris X-Large Steam System, one (1) Claris Flow Meter & one (1) Water Test Kit.

Claris X-Large Filter Cartridge:

- 5-stage filtration process.
- Operation in vertical or horizontal position.
- NSF Certified under NSF/ANSI Standard 42.

Claris Flow Sensor and Display

- Monitors water usage rate to determine cartridge replacement.
- Display indicates cartridge replacement based on gallons of water treated.
- Display unit provides information about residual capacity of installed cartridge, total filtrate volume since flow sensor was installed, filtrate volume and operation time of last five (5) installed cartridges.

Technical Data:

Claris Water Treatment Components

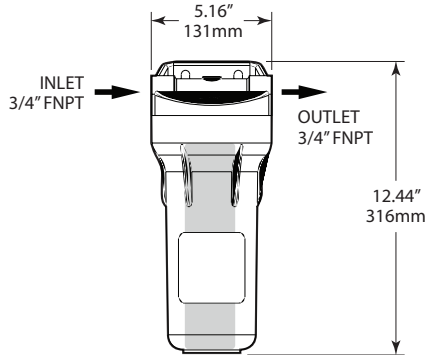

Pre-Filter

Overall Dimensions:	12.44" H x 5.16" W (316mm H x 131mm W)
Inlet Connection:	3/4" FNPT
Outlet Connection:	3/4" FNPT
Service Flow Rate:	Maximum 6.0 gpm (22.7 Lpm)
Pressure Requirement:	35 psi - 70 psi (2.4 – 4.8 bar) non-shock
Water Temperature Inlet Requirement:	39° - 86°F (4° - 30°C)
Electrical:	No electrical connection required
Shipping Weight:	4 lbs.
Operating Weight:	6 lbs.



Flow Meter Sensor

Overall Dimensions:	3.25 W x 2" H x 2" D (83mm W x 51mm H x 51mm D)
Connection:	Inlet: 3/8-inch BSP F nut Outlet: 3/8-inch BSP M
Service Flow Rate:	0.44-3.08 gpm (100-700 LPH)
Pressure Loss:	184 gph (up to 700 LPH flow rate) 3 PSI (0,2 bar)
Pressure Requirement:	35 psi - 70 psi (2.4 – 4.8 bar) non-shock
Ambient Temperature (min/max):	39 - 104 °F (+4 - +40 °C)
Installation Position:	Horizontal recommended

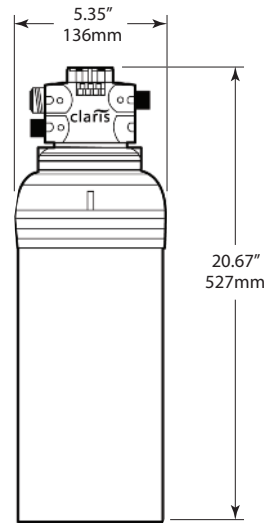

Claris X-Large Filter Cartridge

Overall Dimensions:	20.67" H x 5.35" Dia. (525 mm x 136 mm)
Service Flow Rate:	1.0 gpm (3.7 Lpm)
Treatment Capacity*:	1,100 gal.
Pressure Requirement:	35 psi - 70 psi (2.4 – 4.8 bar) non-shock
Water Temperature Inlet Requirement:	39° - 86°F (4° - 30°C)
Electrical:	No electrical connection required

*Capacity is based on water hardness of 180 ppm.



Programmer & Display

Overall Dimensions:	2.75" H x 2" W (70mm H x 51mm W)
Cable:	59" (1.5 meters)
Electrical:	Lithium Coin Battery (type CR2032)

WATER QUALITY REQUIREMENTS FOR CLEVELAND STEAMERS

TDS	< 60 ppm	pH Factor	7.0 – 8.5
Total Alkalinity	< 20 ppm	Free Chlorine	< 0.1 ppm
Silica	< 13 ppm	Conductivity	min. 20 µS/cm (50 kOhms)
Chloride	< 25 ppm		

NOTES: Proper maintenance of the steam cooking equipment and water treatment system is the responsibility of the owner/operator. Improper installation or maintenance may void the warranty. Refer to the Operators Manual for proper instructions. A water quality analysis is required prior to installing the Claris water treatment system, since water conditions vary throughout the country.

Do not use the "Claris System" with water that is microbiologically unsafe or of unknown quality, without adequate disinfection before or after the system.

NOTES:

Cleveland Range reserves right of design improvement or modification, as warranted. Many regional, state and local codes exist and it is the responsibility of the owner and installer to comply with the codes. Cleveland Range equipment is built to comply with applicable standards for manufacturers.

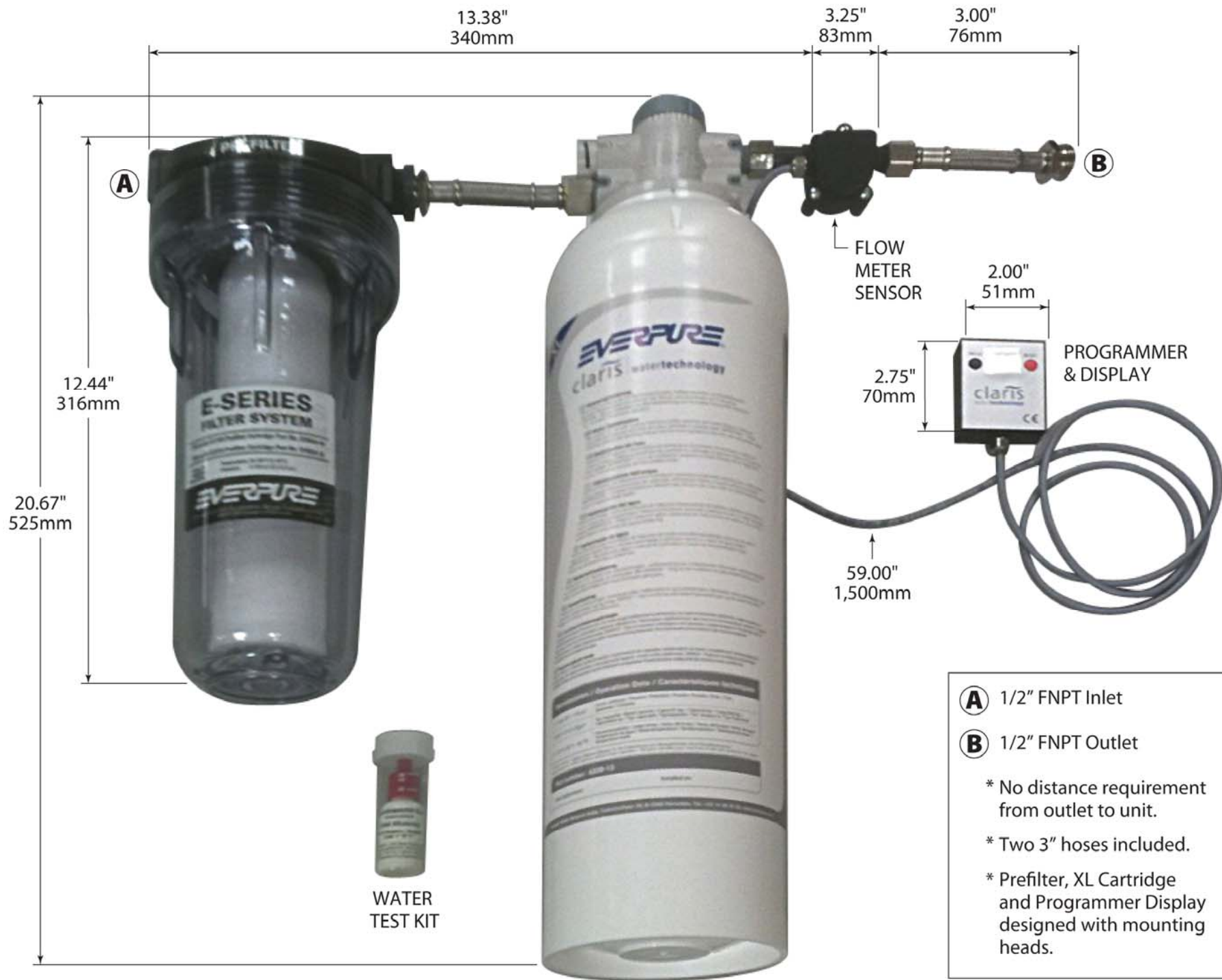

- A** 1/2" FNPT Inlet
- B** 1/2" FNPT Outlet
- * No distance requirement from outlet to unit.
- * Two 3" hoses included.
- * Prefilter, XL Cartridge and Programmer Display designed with mounting heads.

Short installation guide

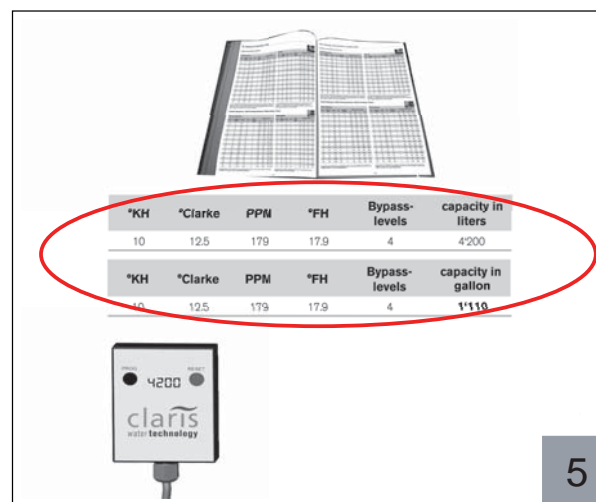
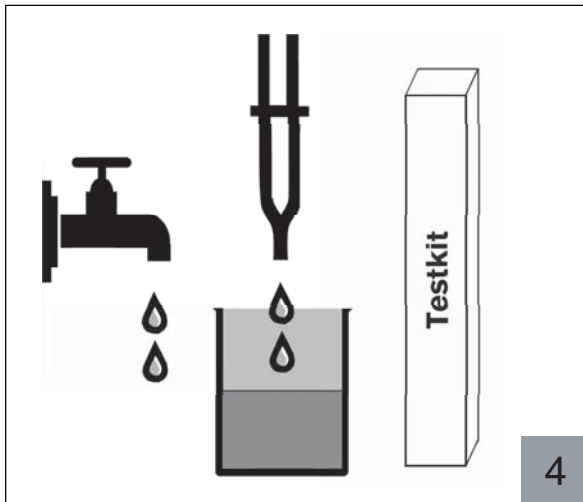
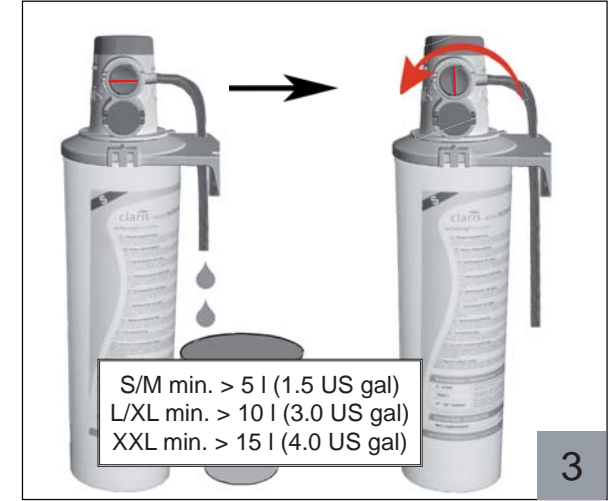
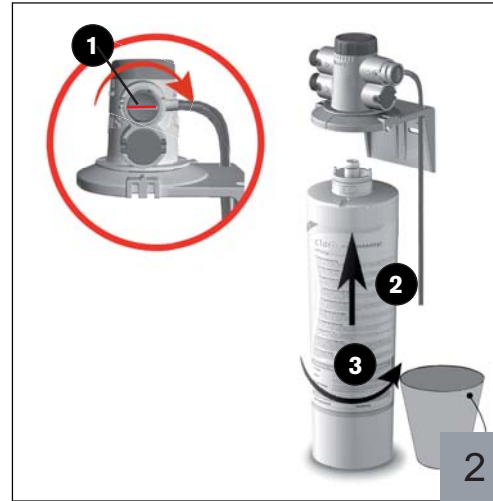
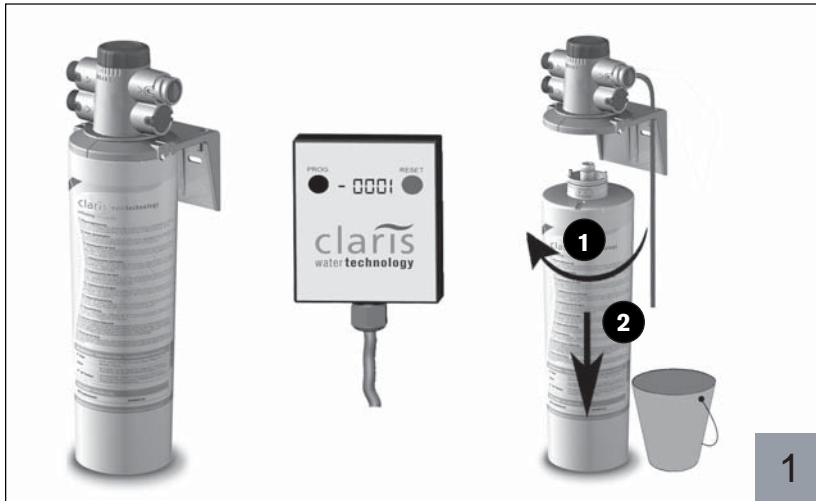

Combi Steamers / Self-Cooking Systems / Steam Cookers / Ovens



Direct Injection									
°KH	Grains (US)	PPM	°FH	By-pass-levels	capacity in US gal				
					S	M	L	XL	XXL
< 6	6	107	11	0	400	660	1'230	1'760	2'910
7	7	125	13	0	340	560	1'060	1'510	2'490
8	8	143	14	0	300	500	930	1'320	2'180
9	9	161	16	0	260	440	820	1'170	1'940
10	10	179	18	0	240	400	740	1'060	1'740
11	11	196	20	0	220	360	670	960	1'580
12	12	214	21	0	200	330	620	880	1'450
13	14	232	23	0	180	300	570	810	1'340
14	15	250	25	0	170	280	530	760	1'240
15	16	268	27	0	160	260	490	700	1'160
16	17	286	29	0	150	250	460	660	1'090
17	18	304	30	0	140	230	440	620	1'020
19	20	339	34	0	120	210	390	560	920
21	22	375	38	0	110	190	350	500	830
23	24	411	41	0	100	170	320	460	760
26	27	464	46	0	90	150	280	410	670
29	30	518	52	0	80	140	250	370	600
33	34	589	59	0	70	120	230	320	530
38	40	679	68	0	60	100	190	280	460

Capacities are intended as guidelines and can vary according the machine typ. Please contact us for recommendations.

Boiler System									
°KH	Grains (US)	PPM	°FH	By-pass-levels	capacity in US gal				
					S	M	L	XL	XXL
< 6	6	107	11	3	570	940	1'760	2'520	4'150
7	7	125	13	3	490	810	1'510	2'160	3'560
8	8	143	14	2	370	620	1'160	1'650	2'720
9	9	161	16	2	330	550	1'030	1'470	2'420
10	10	179	18	2	300	500	930	1'320	2'180
11	11	196	20	2	270	450	840	1'200	1'980
12	12	214	21	2	250	410	770	1'100	1'810
13	14	232	23	2	230	380	710	1'020	1'680
14	15	250	25	2	210	350	660	940	1'560
15	16	268	27	2	200	330	620	880	1'450
16	17	286	29	2	190	310	580	820	1'360
17	18	304	30	2	170	290	540	780	1'280
19	20	339	34	2	160	260	490	700	1'150
21	22	375	38	1	130	210	390	560	920
23	24	411	41	1	110	190	360	510	840
26	27	464	46	1	100	170	320	450	740
29	30	518	52	1	90	150	280	400	670
33	34	589	59	1	80	140	250	350	590
38	40	679	68	1	70	120	220	310	510

Capacities are intended as guidelines and can vary according the machine typ. Please contact us for recommendations.

113583 ¾ X ½ Bushing

113558 Hose

113556
Claris
Head

battery (type CR2032)
Local Purchase

113560
10"
Prefilter

113557 Flow Meter

113559
Test Kit

113587 O-ring

113555 Claris XL
Cartridge

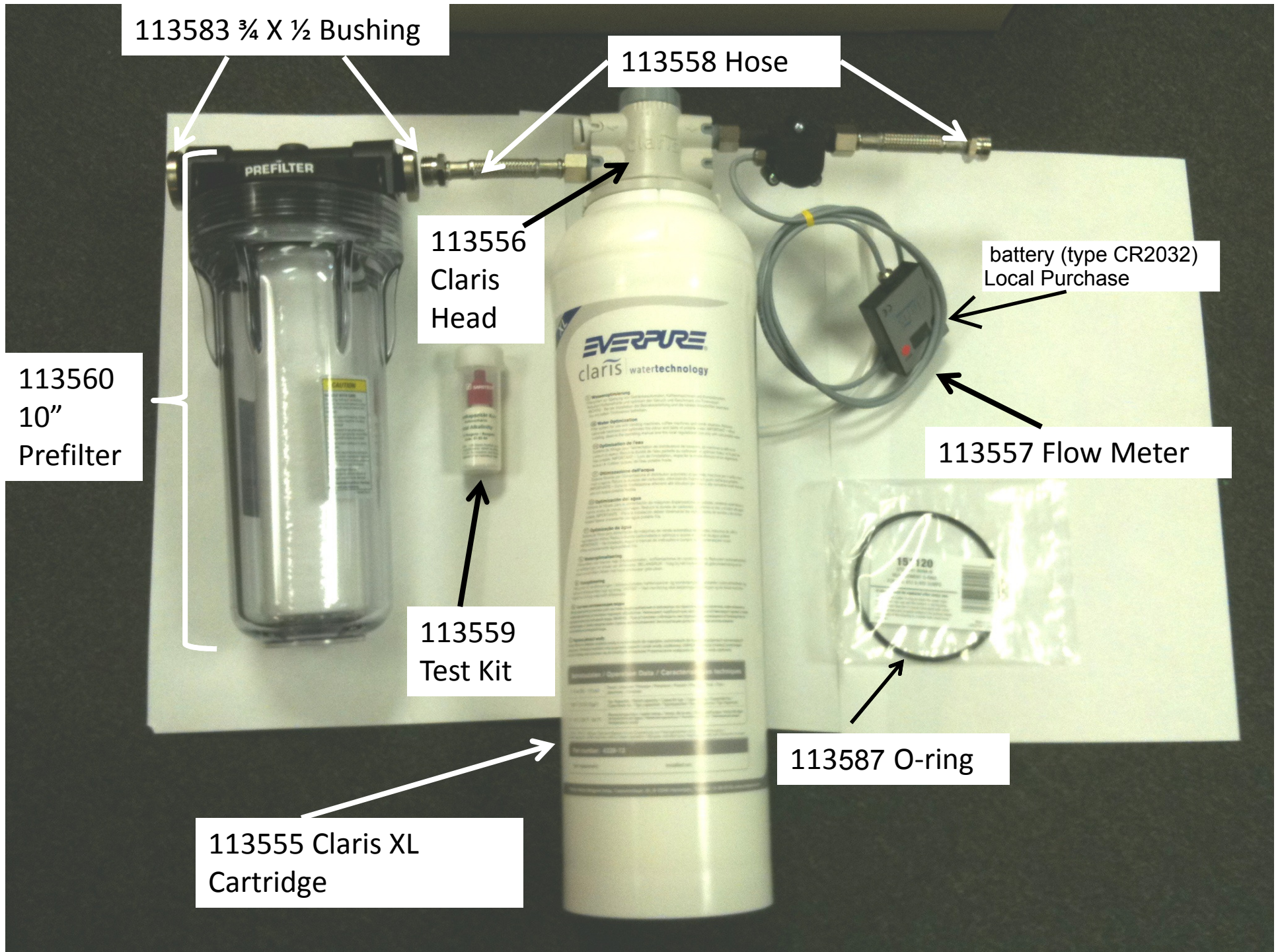

113562
Prefilter
Cartridge



113587 O-Ring



113583 3/4 X 1/2
Bushing



113589 Prefilter head



113588 10"
Clear Bowl



113586 Wrench