

# FK110758 Block-Off Plate Assembly

|    |            |         |
|----|------------|---------|
| LC | REV        | DATE    |
| A  | PRODUCTION | 4-24-02 |



**STEP 1**  
CLEAN GASKET AREA WITH A WIRE BRUSH.



**STEP 2**  
INSTALL GASKET OVER REMAINING HEATER MOUNTING STUDS.

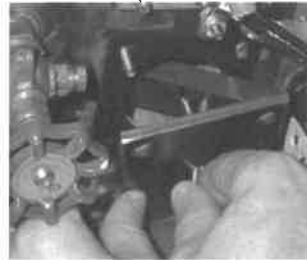

**STEP 4**  
INSERT CLAMP BAR INTO BOILER HEATER HOLE WHILE RESTING BLOCK-OFF PLATE ON #6-32 SCREW.

POSITION CLAMP BAR STOP TO THE RIGHT SIDE OF CLAMP BAR.



POSITION CLAMP BAR STOP TO THE RIGHT SIDE OF BAR CLAMP.

**STEP 3**

WITH #6-32 SCREW SCREWED INTO CLAMP BAR STUD, PULL #6-32 SCREW THROUGH THE HOLE IN BLOCK-OFF PLATE.

**WARNING:**  
DISCONNECT POWER AND DRAIN BOILER BEFORE REMOVING EXISTING BLOCK-OFF PLATE AND INSTALLING REPLACEMENT BLOCK-OFF PLATE.



SEALING SIDE OF NUT

SEALING NUT

**STEP 6**

HOLD STUD WHILE PLACING SEALING NUT OVER #6-32 SCREW WITH SEALING SIDE OF NUT FACING BLOCK-OFF PLATE SURFACE.



**STEP 7**  
THREAD NUT ONTO CLAMP BAR STUD WHILE HOLDING #6-32 SCREW.



**STEP 8**  
REMOVE #6-32 SCREW FROM CLAMP BAR AND TIGHTEN NUT (25-40 IN. -LBS.) WHILE POSITIONING PLATE OVER HEATER MOUNTING STUD BASES.



**STEP 9**  
INSTALLATION COMPLETE. RECONNECT POWER AND CHECK FOR LEAKS.

**CAUTION:**  
DISCONNECT POWER BEFORE TIGHTENING NUT IF LEAKS ARE PRESENT.

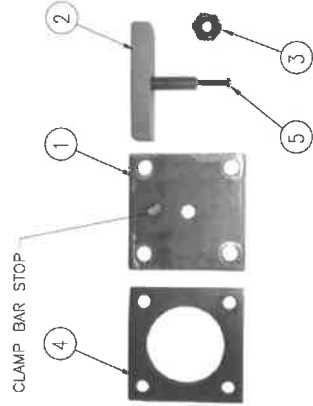

| QTY | DESCRIPTION                                    | UNIT |
|-----|--|------|
| 5   | 106228 SCREW, 6-32 X 1, TORX SLOT HD, SELF TAP |      |
| 4   | 07128 GASKET                                   |      |
| 3   | 110764 SEALING NUT                             |      |
| 2   | 110761 WELDMENT CLAMP BAR                      |      |
| 1   | 110758 WELDMENT BLOCK-OFF PLATE                |      |

|         |     |
|---------|-----|
| DATE    | BY  |
| 4-24-02 | DRL |

|       |         |             |
|-------|---------|-------------|
| SCALE | DATE BY | APPROVED BY |
| N/A   | DRL     |             |

|          |      |    |
|----------|------|----|
| DESIGNER | DATE | BY |
|          |      |    |

|          |   |
|----------|---|
| REVISION | DESCRIPTION   |
| 1        | CLEVELAND RANGE INC.<br>1325 East 17th St. Cleveland, Ohio 44115-2574 |

|         |           |
|---------|-----------|
| DATE    | ISSUED BY |
| 4-24-02 | D-110759  |