

Installation Instructions

Mounting Kit for Two Gas SteamChef 22CGT3.1 or 22CGT6.1 Steamers Or 22CCT6 Electric Steamers Mounted on a Model ES263044 Equipment Stand, p/n 113130G or p/n 113131G

This kit (p/n 113124) is for mounting (2) SteamChef 22CGT3.1 or 22CGT6.1 Steamers or 22CCT6 on a Model ES263044 Equipment Stand, p/n 113130G or 113131G.

The Installation of Cleveland Range steamers on the ES263044 Equipment Stand should only be performed by Cleveland Range authorized technicians.

Read the entire installation procedure before beginning.

The installer must be familiar with this procedure, and the instructions supplied with each SteamChef Steamer, Cleveland Range P/N 22CGT3.1&6.1-INM, P/N 22CGT3.1&6.1-OPM, P/N KE004048 and P/N KE004049.

Item Number on Drawings	Quantity	Part Number	Description
28	8	FA30506	WASHER; 3/8 18-8 SS
27	8	FA31031	SPLIT LOCKWASHER;3/8, 18-8 S/S
26	8	FA11384	HEX BOLT (18-8 S/S), 3/8-16 X 1 LG
25	1	112523	WARNING LABEL, BURN AND SCALD HAZARD (SEE FIG. 2)
24	3	19148	SCREW, HEX WASHER HD, #10 X 1/2 , TYPE AB, ZINC PLTD
23	1	113001	FLUE RISER ASSY, CHEF 6.1
22	1	113028	ASSEMBLY, FLUE ADAPTER
21	7	108734	NUT, "U" TYPE (EXTRUDED) #10-24 UNC-2B THREAD
20	7	101231	SCREW, 10-24 X 0.500 SST, PHILLIPS TRUSS HEAD
19	1	112490	ASSEMBLY, REAR FLUE COVER
18	1	112489	COVER, FLUE ADAPTER, FRONT
17*	4	110921	FITTING, 1/4 – 18 NPTF X 3/4 – 11.5 NH, BRASS
16	2	111000	FITTING, WYE, GHTF X (2) GHTM, BRASS
15*	4	110987	STRAINER, FILTER WASHER, GARDEN HOSE INLET (GHT)
14	2	111160	HOSE ASSEMBLY, GHT (F) X 39" LONG
13	1	05238	ELBOW, 90, 1-1/2" NPT, BLK
12	1	1054693000	HOSE, BLACK EPDM, 1" ID X 30" LONG
11	2	03204	CLAMP, HOSE, WORM DRIVE, .812-1.50 DIA
10	2	14481	FITTING, 1" HOSE X 1" NPT (M)
9	2	02573	BUSHING, HEX, 1" NPT X 1-1/2" NPT, BLK
8	1	20221	TEE, 1 1/2" NPT, BLK
7	2	110985	FITTING, HOSE BARB, 1-1/2"HOSE X 1-1/2" NPT (M)
6*	4	102018	CLAMP, HOSE, WORM DRIVE, 1.5 – 2.0 DIA.
5*	2	1109840300	HOSE, EPDM, 1-1/2" ID X 3.00" LG.
4	8	111013	WASHER, FENDER, 17/32" ID X 1.5" OD
3	8	23153	WASHER, LOCK, 1/2", SST
2	8	111012	SCREW, 1/2 – 13 , HEX HEAD
1	1	ES263044	EQUIPMENT STAND, ASSEMBLY, STACKED

*NOTE: Items 5, 6, 15, and 17 are supplied with the steamer and not included with stacking kit hardware.

18301 St. Clair Street
Cleveland, Ohio 44110
Phone: (216) 481-4900
Fax: (216) 481-378
www.clevelandrange.com



CLEVELAND

This kit is for mounting (2) SteamChef 22CGT3 or 22CGT6 steamers on a Model ES263044 Equipment Stand, p/n 113130G or p/n 113131G.

The Installation of Cleveland Range steamers on the ES263044 Equipment Stand should only be performed by Cleveland Range authorized technicians.

Read the entire installation procedure before beginning.

The installer must be familiar with this procedure, and the instructions supplied with each SteamChef Steamer, Cleveland Range P/N 22CGT3.1&6.1-INM, P/N 22CGT3.1&6.1-OPM.

1. Position stand in the selected location so that the feet with round mounting pads are at the rear.
2. Use the adjustable feet to level the stand front-to-back and side-to-side.
3. The stand must be anchored to floor through holes in the round mounting pads in the rear feet.
4. Do NOT screw the 4" legs into steamers. The 4-inch legs provided with the steamers are not used when installing SteamChef steamers on a stand.
5. Set the **LOWER** steamer on the stand as shown in Figure 3.
6. Align the steamer so that the left front and right rear mounting bolts will come up through holes "A" indicated in Figure 1.
7. Secure the lower steamer to the stand using the hardware provided. See Figure 3.
8. Remove the side panels and seal any gaps between steamer and stand with a suitable RTV Sealant (not provided).
9. Repeat Steps 1-8 for the upper steamer.

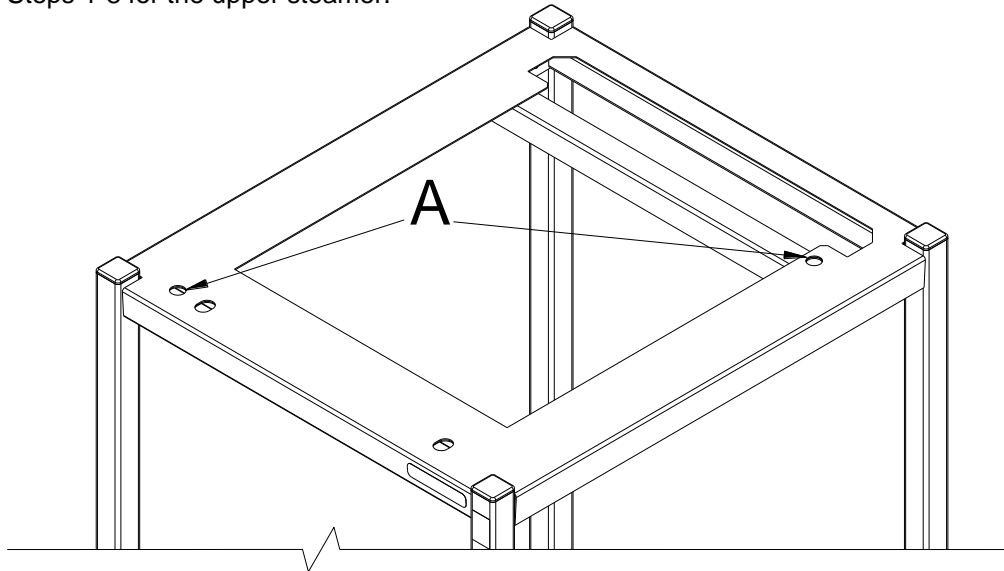

Figure 1
SteamChef Mounting Holes

10. Attach drain fittings as shown in Figure 3.
 - Use a suitable pipe thread sealant or Teflon tape (not provided) on all NPT threaded connections.
 - Use a suitable plain washer or strainer washer at all Garden Hose threaded connections. See Figure 3 for strainer washer locations.
 - **DO NOT USE PIPE THREAD SEALANT OR TEFLON TAPE ON GARDEN HOSE THREADED CONNECTIONS.**
11. Check length of drain hose (Figure 3, Item 12) and shorten if necessary.
12. Place worm drive clamps (Figure 3, Item 11) over hose and push hose onto upper hose fitting.
13. Slightly rotate lower tee and hose fitting counter-clockwise until lower end of hose can start onto fitting.
14. Slide hose fully onto fitting by rotating tee and fitting back to their original vertical position.
15. Secure hose to fittings with worm drive clamps.

16. Attach inlet water trains for reservoir and condenser as shown in Figure 3. (Items 14 – 17).
 - Each SteamChef steamer is supplied with strainer washers (Figure 3, Item 15) for use on the water inlets. **THESE STRAINER WASHERS MUST BE USED ON THE STEAMER WATER INLET CONNECTIONS.**
17. After RTV sealant has set, replace side panels.
 - Do not seal side panels to unit.
 - Side panels must be easily removable for service access.
18. Install the flue assembly as shown in Figure 4, 5, 6, and 7.
 - a. Attach the flue adapter (Figure 4, 5, 6, 7, Item 22) to the unit as shown in Figure 4, 5, 6 and 7.
 - b. Attach the flue riser (Figure 4, 5, 6, 7, Item 23) to the flue adapter as shown in Figure 4, 5, 6 and 7.
 - c. Attach the flue adapter cover (Figure 4, 5, 6, 7, Item 18) to the flue cover of the bottom steamer as shown in Figure 4, 5, 6 and 7.
 - d. Slide the rear flue cover (Figure 4, 5, 6, 7, Item 19) over the flue riser as shown in Figure 4, 5, 6, and 7.
 - e. Secure the rear flue cover to the flue riser and each unit's flue cover with one screw on the back and two screws on each side as shown in Figure 4, 5, 6, and 7.
19. Complete the installation of the steamers as outlined in the SteamChef Installation Manual, P/N 22CGT3.1&6.1-INM and Operator's Manual, 22CGT3.1&6.1-OPM.
20. Place the Burn and Scald Hazard warning label on the door of the LOWER steamer as shown in Figure 2.

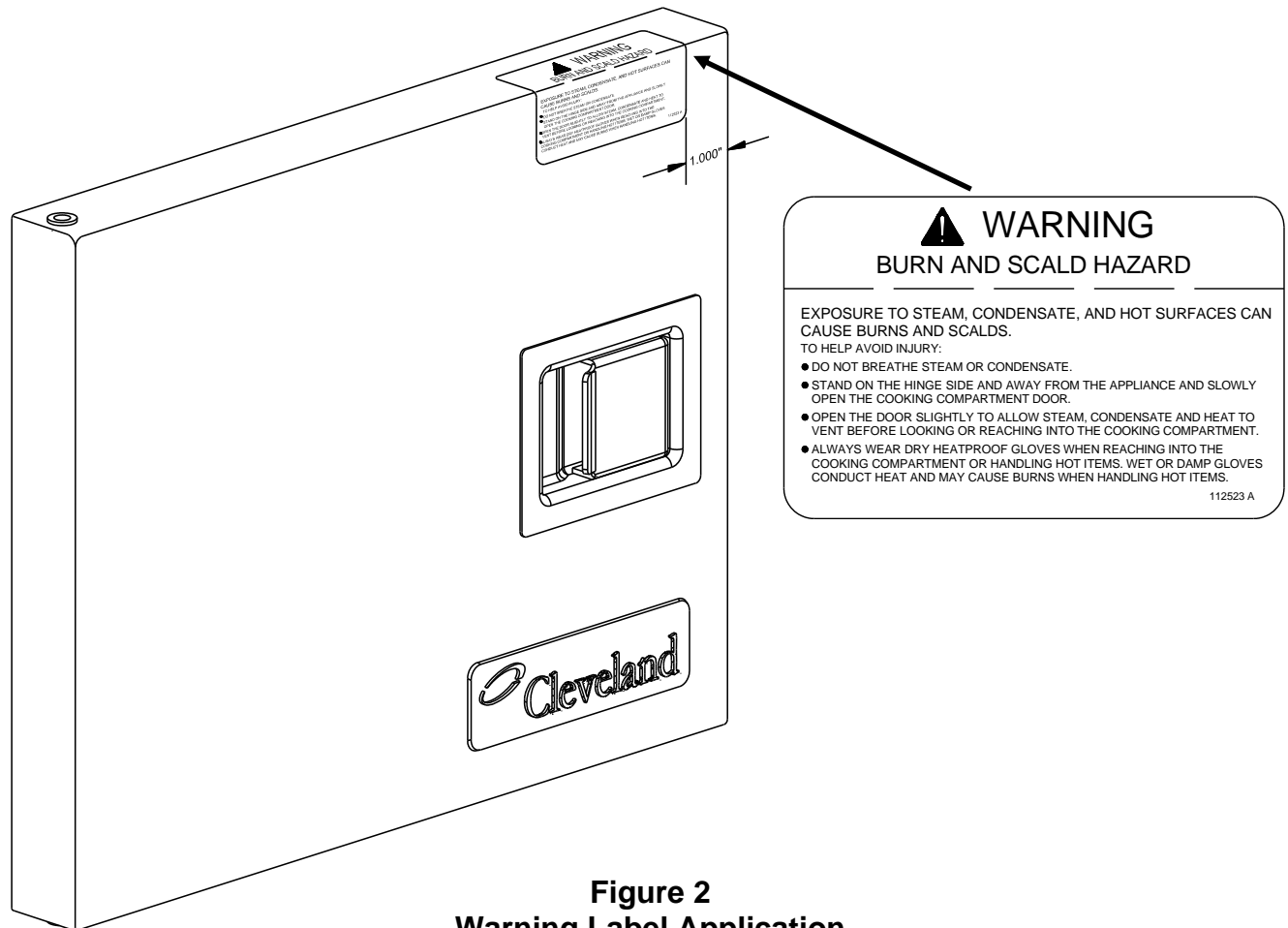

Figure 2
Warning Label Application

SteamChef™ 6 Stand Mounting Kit, P/N KE004073 (Not Included with Stand)

1	KE604153	FOOT ADAPTER; STACK STAND LEG; 22CCT6	4
---	----------	---------------------------------------	---

See Pages 12 - 13 for Installation of SteamChef™ 6 Steamers

This kit is for mounting (2) SteamChef™ 6 Steamers on a Model ES263044 Equipment Stand, p/n 113130G or p/n 113131G.

The Installation of Cleveland Range steamers on the ES263044 Equipment Stand should only be performed by Cleveland Range authorized technicians.

Read the entire installation procedure before beginning.

The installer must be familiar with this procedure, and the instructions supplied with each SteamChef™ 6 Steamer, Cleveland Range P/N KE004048 and KE004049.

1. Position stand in the selected location so that the feet with round mounting pads are at the rear.
2. Use the adjustable feet to level the stand front-to-back and side-to-side.
3. The stand must be anchored to floor through holes in the round mounting pads in the rear feet.
4. Do NOT screw the 4" legs into steamers. The 4-inch legs provided with the steamers are not used when installing SteamChef™ 6 steamers on a stand.
5. Set the **LOWER** steamer on the stand as shown in Figure 9.
6. Align the steamer so that the left front and right rear mounting bolts will come up through holes "A" indicated in Figure 1.
7. Secure the lower steamer to the stand using the hardware provided. See Figure 9.
8. Repeat Steps 1-8 for the upper steamer.

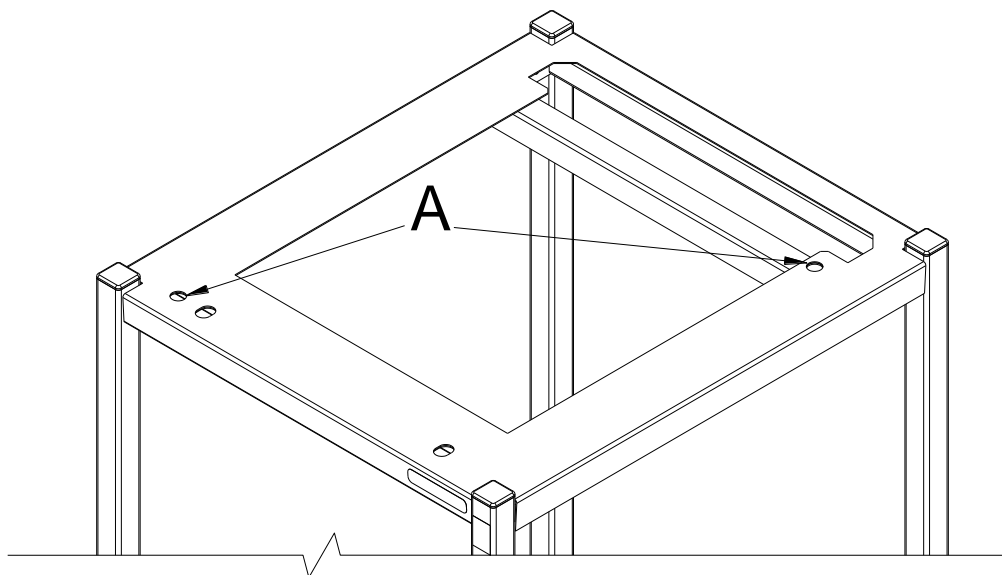
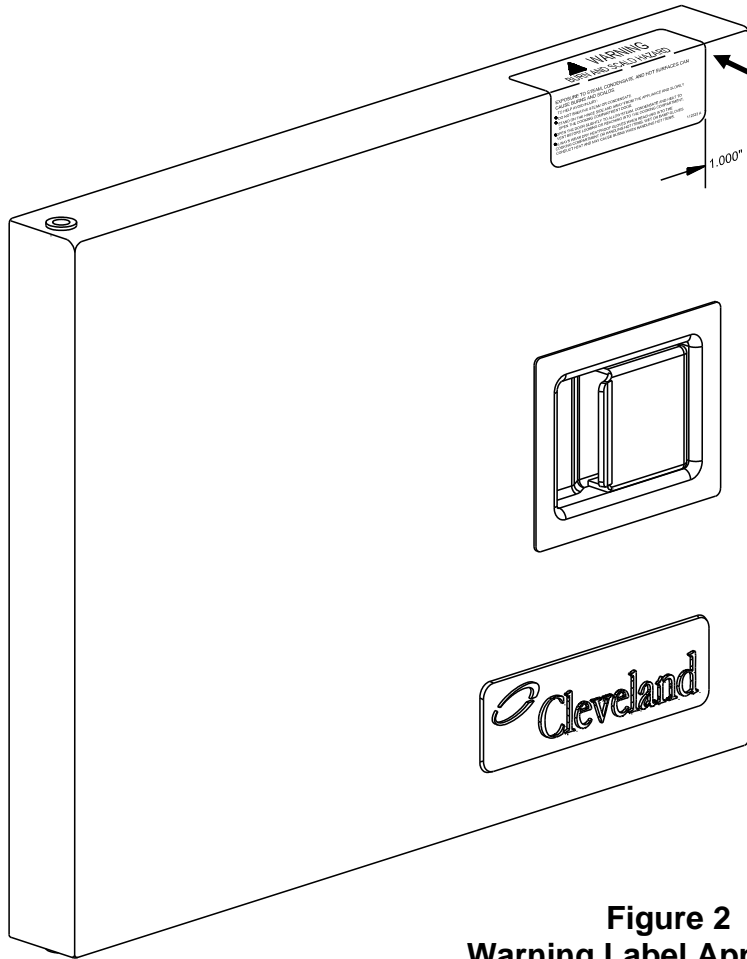

Figure 1
SteamChef Mounting Holes

9. Complete the installation of the steamers as outlined in the each SteamChef™ 6 Steamer Installation Manual, Cleveland Range P/N KE004048 and KE004049
10. Place the Burn and Scald Hazard warning label on the door of the LOWER steamer as shown in Figure 2.
11. See Page 11 to 12 for Detailed Installation Instruction of SteamChef™ 6 on a Model ES263044 Equipment Stand.



⚠ WARNING
BURN AND SCALD HAZARD

EXPOSURE TO STEAM, CONDENSATE, AND HOT SURFACES CAN CAUSE BURNS AND SCALDS.

TO HELP AVOID INJURY:

- DO NOT BREATHE STEAM OR CONDENSATE.
- STAND ON THE HINGE SIDE AND AWAY FROM THE APPLIANCE AND SLOWLY OPEN THE COOKING COMPARTMENT DOOR.
- OPEN THE DOOR SLIGHTLY TO ALLOW STEAM, CONDENSATE AND HEAT TO VENT BEFORE LOOKING OR REACHING INTO THE COOKING COMPARTMENT.
- ALWAYS WEAR DRY HEATPROOF GLOVES WHEN REACHING INTO THE COOKING COMPARTMENT OR HANDLING HOT ITEMS. WET OR DAMP GLOVES CONDUCT HEAT AND MAY CAUSE BURNS WHEN HANDLING HOT ITEMS.

112523 A

Figure 2
Warning Label Application

NOTES

1. SET THE UNITS ONTO THE STAND AND ATTACH THEM WITH THE SETS OF BOLTS, LOCK WASHER AND WASHERS PROVIDED.
2. INSTALL THE PLUMBING AND DRAIN AS SHOWN. ALL THREADED PLUMBING (EXCEPT THOSE OF THE HOSE THREAD TYPE, ITEMS 6, 17 AND 18) REQUIRES THE USE OF PIPE SEALANT OR TEFLON TAPE (NOT PROVIDED).
3. THE END OF THE DRAIN MANIFOLD MUST BE EXTENDED TO A SUITABLE DRAIN. DO NOT PLUMB THE DRAIN SOLID TO THE FLOOR DRAIN, BUT INSTALL IT "FREE AIR VENTED". THERE MUST BE A 1" AIR GAP AT THE DRAIN END. IMPORTANT: WHEN STACKED, A 2" MINIMUM DRAIN CONNECTION IS REQUIRED BETWEEN THE OUTLET OF THE COMMON DRAIN AND THE FLOOR DRAIN. UNDER NO CIRCUMSTANCES SHOULD THE DRAIN PIPING EVER BE SIZED SMALLER THAN COMMON DRAIN OUTLET.
4. SEE INSTALLATION INSTRUCTIONS P/N 22CGT3.1 & 6.1-1NM FOR ADDITIONAL DETAILS OF STEAMCHEF INSTALLATION.
5. SUPPLIED WITH STEAMER, NOT PART OF THE KIT.
6. SEAL ANY GAPS BETWEEN THE STEAMERS AND THE STAND WITH A SUITABLE FOOD GRADE RTV SILICONE SEALANT (NOT PROVIDED) RATED AT LEAST 250°F AND LISTED OR CLASSIFIED TO THE NSF/ANSI 51 OR 61 STANDARDS.
7. ITEM #2 & 3 ARE REQUIRED FOR UNITS BUILT BEFORE OCTOBER 2020.
8. ITEM #26, 27 & 28 ARE REQUIRED FOR UNITS BUILT AFTER OCTOBER 2020.

Figure 3

Gas SteamChef 3.1 + 3.1
 Gas SteamChef 6.1 + 6.1
 Gas SteamChef 3.1 + 6.1

Plumbing and Drain connections

Gas SteamChef 6.1 + 6.1
 on 1131 30G Stand Shown

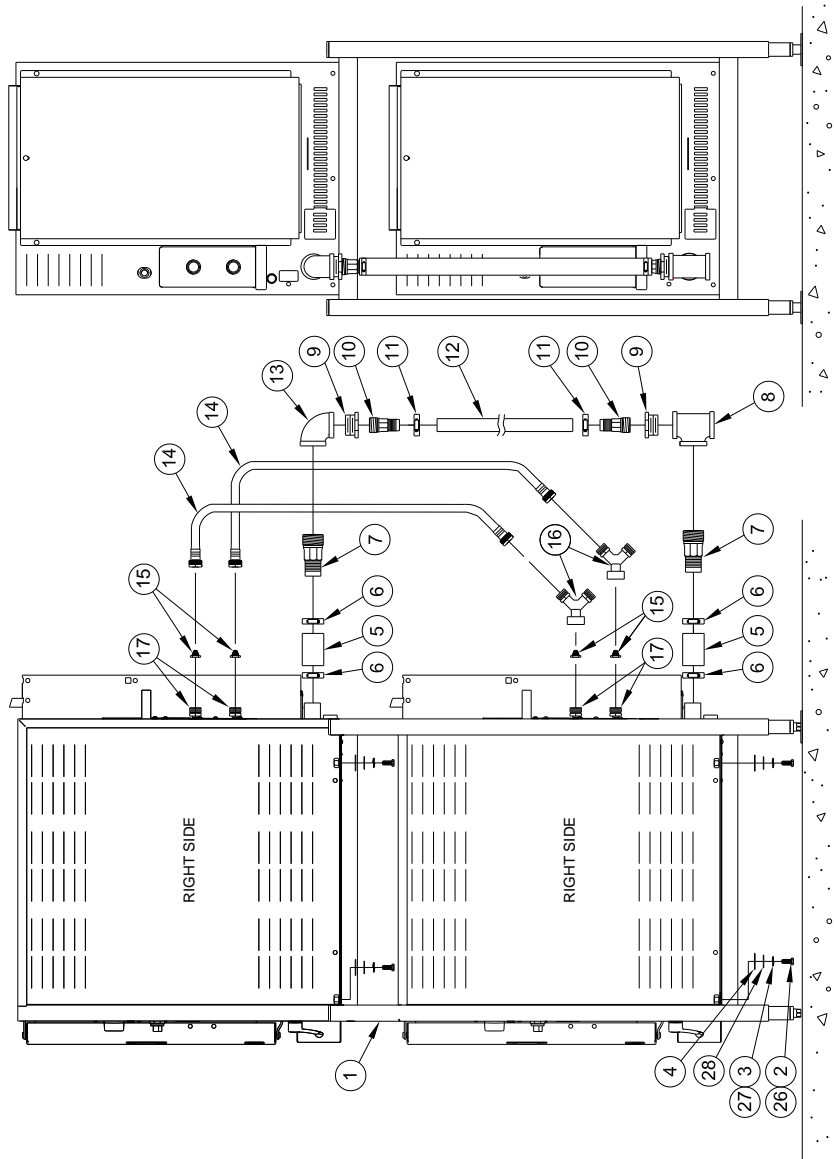

28	8	FA30506	WASHER, 3/8 1/4-28 SS
27	8	FA1031	SPLIT LOCK WASHER, 3/8 1/4-28 SS
26	8	FA1384	HEX BOLT 1/64 SS, 3/8-16 X 1 LG
17	4	110921	FITTING, 1/4-18 NPT X 3/4-1.5 NH, BRASS
16	2	111000	FITTING W/VE, GHT F X 2 GHTM, BRASS
15	4	110897	STRAINER, FILTER WASHER, GARDEN HOSE INLET (GHT)
14	2	111180	HOSE ASSEMBLY, GHT F X 3/8" LONG
13	1	05228	ELBOW, 90, 1/2" NPT, BLK
12	1	105493001	HOSE, BLACK EPDM, 1" ID X 30" LONG
11	2	03204	CLAMP, HOSE, WORN DRIVE, 8/12-1.50 DIA
10	2	14481	FITTING, 1" HOSE X, 1" NPT (M)
9	2	02573	BUSHING, HEX, 1" NPT X, 1/2" NPT, BLK
8	1	20221	TEE, 1 1/2" NPT, BLK
7	2	110865	FITTING, HOSE BARB, 1/2" HOSE X 1/2" NPT (M)
6	4	102018	CLAMP, HOSE, WORN DRIVE, 1.5-2.0 DIA
5	2	110840300	HOSE EPDM, 1/2" ID X 3.00" LONG
4	8	111013	WASHER, FEEDER, 1/32" ID X 1.500
3	8	23163	WASHER, LOCK, 1/2" INK SST
2	8	111012	SCREW, 1/2 X 1.0, 700, HEX HEAD, S.S.
1	1	ES203044	EQUIPMENT STAND, ASSEMBLY, STACKED

NOTE 8

NOTE 5

NOTE 5

NOTE 5

NOTE 7

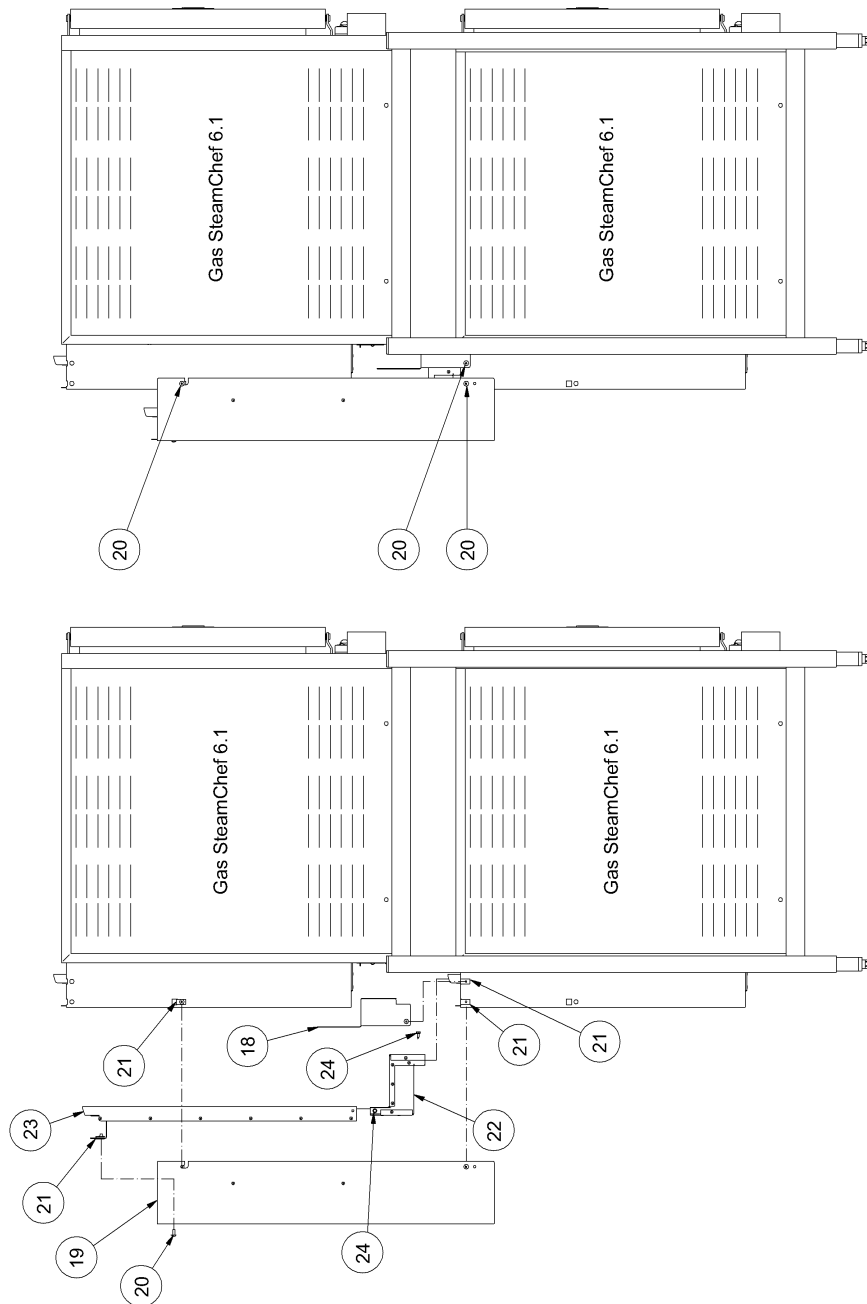

Figure 4

Gas SteamChef 6.1 + 6.1 on 113130G stand
Flue Extension Assembly

Note: Plumbing and Drain connections same as Figure 3.

ITEM	QTY	PART NO.	DESCRIPTION
24	3	19146	SCREW, HEX WASHER HD, #10 x 1/2, TYPE A8, ZINC PLTD
23	1	113001	FLUE RISER ASSY CHEF 6.1, GAS
22	1	113028	ASSEMBLY, FLUE ADAPTER
21	7	108734	NUT, "U" TYPE EXTRUDED #10-24 UNC-2B THREAD
20	8	101231	SCREW, 10-24 X 0.50, SST, PHILLIPS TRUSS HEAD
19	1	112480	ASSEMBLY, REAR FLUE COVER
18	1	112489	COVER, FLUE ADAPTER FRONT

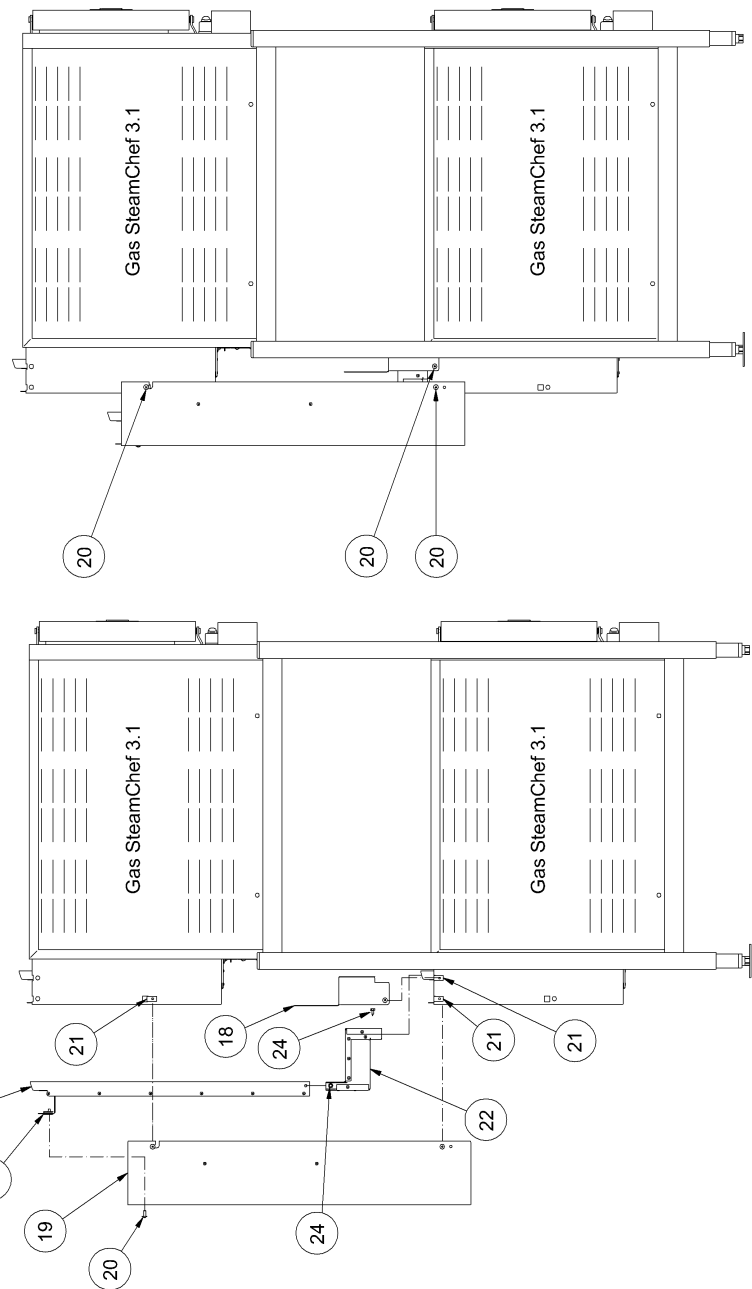

Figure 5

Gas SteamChef 3.1 + 3.1 on 113130G stand
Flue Extension Assembly

Note: Plumbing and Drain connections same as Figure 3.

ITEM	QTY	PART NO.	DESCRIPTION
24	3	19148	SCREW, HEX WASHER HD, #10 X 1/2, TYPE A6, ZINC PLTD
23	1	113001	FLUE RISER ASSY/CHIEF 6, 1, GAS
22	1	113028	ASSEMBLY, FLUE ADAPTER
21	7	108734	NUT, 1/2" TYPE (EXTRUDED) #10-24 UNC, 26 THREAD
20	8	101231	SCREW, 10-24 X 0.500 SST, PHILLIPS TRUSS HEAD
19	1	112460	ASSEMBLY, REAR FLUE COVER
18	1	112469	COVER FLUE ADAPTER FRONT

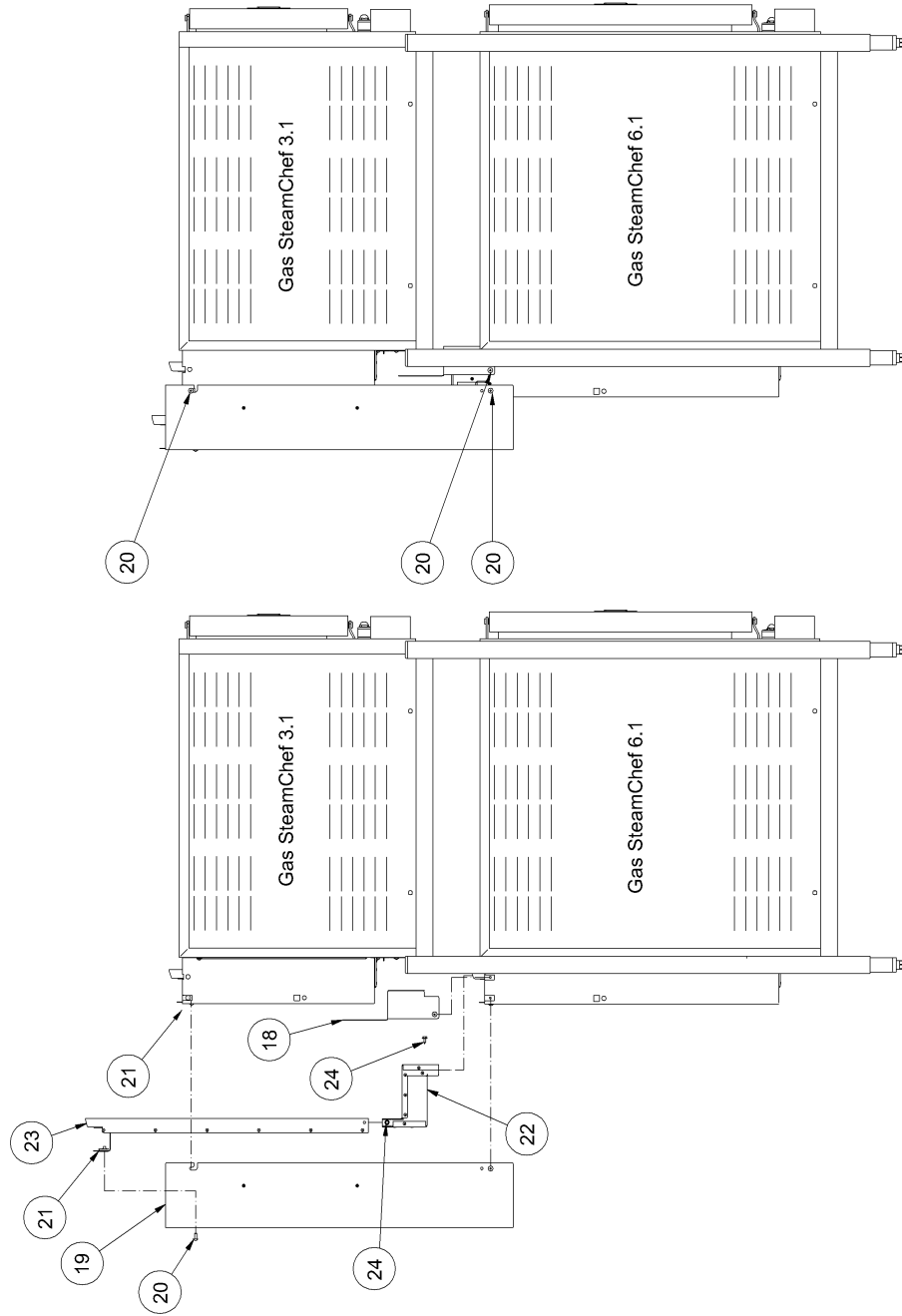

Figure 6

Gas SteamChef 3.1 + 6.1 on 113130G stand
Flue Extension Assembly

Plumbing and Drain connections same as
Figure 3.

ITEM	QTY	PART NO.	DESCRIPTION
24	3	19148	SCREW, HEX WASHER-HD, #10 X 1/2, TYPE AB, ZINC PLTD
23	1	113001	FLUE RISER ASSY CHEF 6.1 GAS
22	1	113028	ASSEMBLY, FLUE ADAPTER
21	7	106794	NUT, "O" TYPE (EXTRUDED) #10-24 UNC-2B, THREAD
20	8	101231	SCREW, 10-24 X 0.600 SST, PHILLIPS TRUSS HEAD
19	1	112600	ASSEMBLY, REAR FLUE COVER
18	1	112688	COVER, FLUE ADAPTER FRONT

Figure 7
Gas SteamChef 3.1 + 3.1 on 113131G stand
Flue Extension Assembly

Note: Plumbing and Drain connections same as Figure 3.

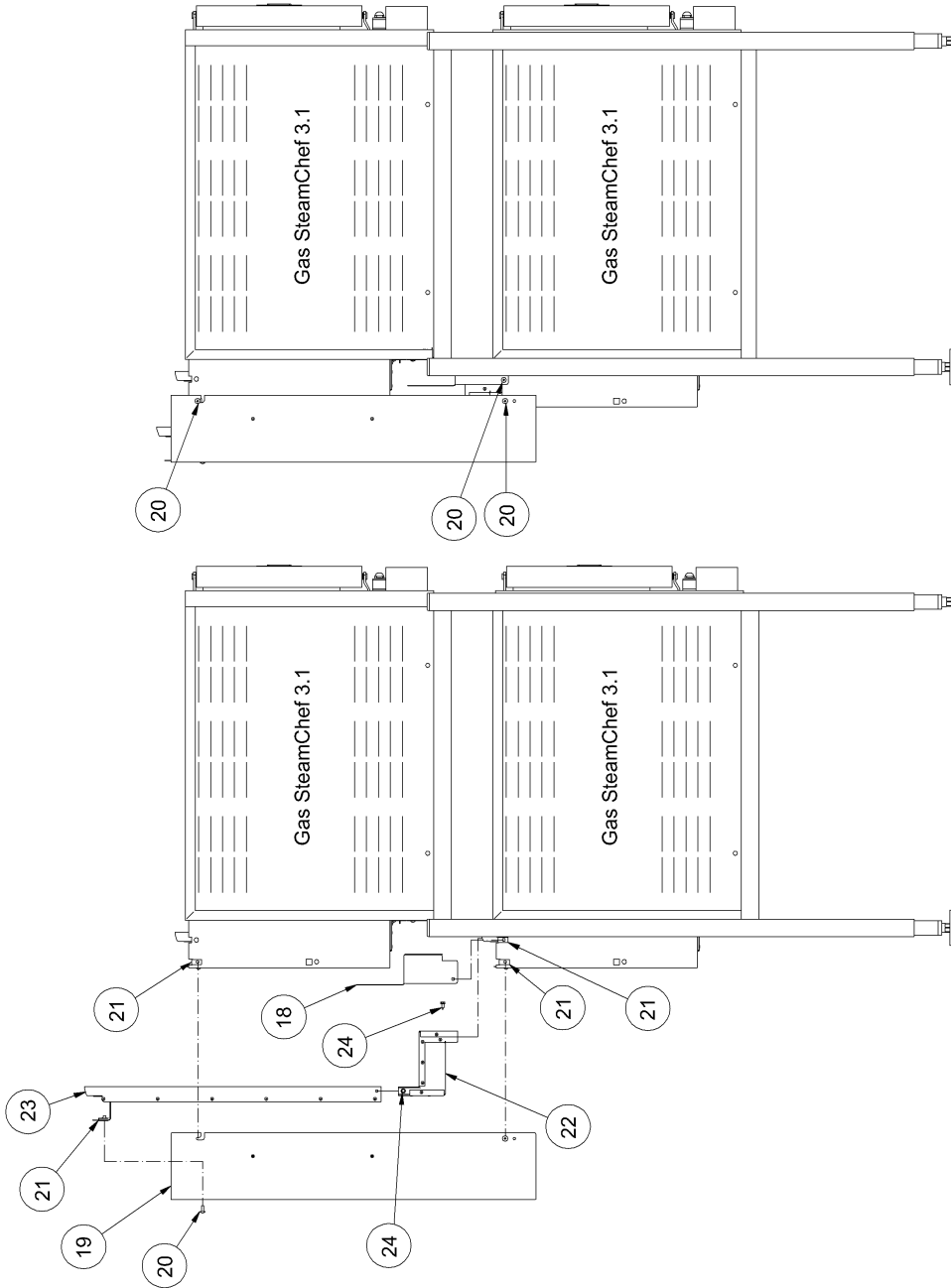

ITEM	QTY	PART NO.	DESCRIPTION
24	3	19148	SCREW, HEX WASHER,HD #10 X 1/2, TYPE AB, ZINC PLTD
23	1	113001	FLUE RISER ASSY,CHEF 6.1, GAS
22	1	113028	ASSEMBLY, FLUE ADAPTER
21	7	108734	NUT, U-TYPE (EXTRUDED) #10-24 UNC-2B THREAD
20	8	101231	SCREW, 10-24 X 0.500 SST, PHILLIPS TRUSS HEAD
19	1	112480	ASSEMBLY, REAR FLUE COVER
18	1	112489	COVER, FLUE ADAPTER FRONT

SteamChef™ 6 Steamer Installation

(Model 22CCT6)

In addition to knowledge of this procedure, installer must be familiar with the instructions supplied with each SteamChef™ 6 steamer. These instructions are part of Cleveland Range P/N KE004048 and KE004049.

For this installation, SteamChef™ 6 Stand Mounting Kit, P/N KE004073, is required and must be ordered separately as it is not included with stand.

To Mount the SteamChef™ 6 steamer on the ES263044 Equipment Stand, you must first take out the Aluminum Foot Leveling for leg P/N KE604161 and replace all 4 legs with new S.S. adapters P/N KE604153 that are included in the SteamChef™ 6 Stand Mounting Kit, P/N KE004074 as shown in the below Pictures.

1. By using a Snap Ring Tool Remover, Remove the Snap Ring from the bottom of the foot leveler P/N KE604161
2. Unscrew the Foot Leveler P/N KE604161 from all 4 legs and Replace them with the new S.S. adapters P/N KE604153 (See Pictures Below)



Figure 8
SteamChef™ 6 Re-Placement with new Foot Adapter

3. Screw four legs with new SS adapters of SteamChef™ 6 into nuts inside bottom of steamers as shown in Figure 9 (Items 1 and 2) on the following page.
4. Align steamers so that mounting bolts come up through holes marked “B” in Figure 1 (Page 4)
5. Rest the S.S. foot adapters from each leg of the steamers onto stand so the foot adapters holes are concentric with the holes on ES263044 Equipment Stand and resting on the top of stand. (See Figure 9)

6. Secure steamers to stand using four special Washers nuts P/N 111013 (Item 4), four 1/2 Lock washers P/N 23153 (Item 5), and four 1/2-13 Hex head bolt P/N 111012 (Item 6) from ES263044 Equipment Stand Parts kit as shown in Figure 9. Tighten the 1/2-13 Hex head screws so that the SteamChef™ 6 is secure to stand.
7. Complete installation of steamer as outlined in its installation manual.

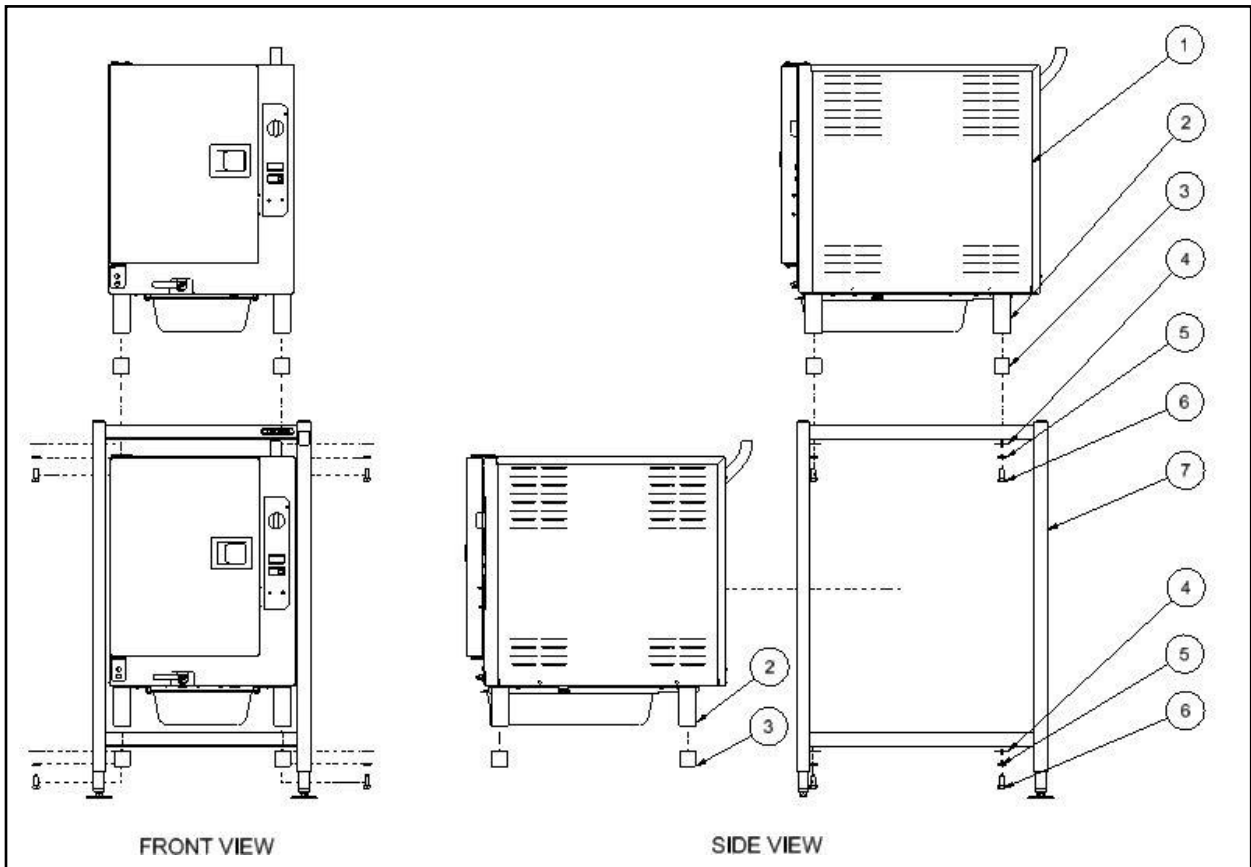

*Supplied-with or Part-of SteamChef™ 6 Steamer

Figure 9
SteamChef™ 6 Mounting Instructions
(Model 22CCT6 shown on ES263044 Equipment Stand)

Item No.	Part No.	Description	Quantity
1	-	SteamChef™ 6 Steamer (SteamChef™ 6 22CCT6 Shown)	1
2	KE003943*	Weldment; Leg; 22CCT6	4
3	KE604153	Foot Adapter; Stand Leg; 22CCT6	4
4	111013	Washer, Fender, 17/32" ID x 1½" OD, SST	4
5	23153	Washer, Lock, ½, SST	4
6	111012	Screw, Hex Head, ½-13 x ¾" Long, SST	4
7	111764	Unistand25 Equipment Stand Assembly	1

This Page for Internal Record Only, Not for Printing

Cleveland Range, LLC

18301 St. Clair Street, Cleveland, Ohio 44110

Drawing No. 260BDH

Revision Index Page

LET	REVISION HISTORY	DATE	BY
A	Production Release Per ECR-09-076	4/14/ 2009	JTW
B	Revised quantity and part no. list; revised item references on pages 2 & 3; added Fig.4; revised Figure titles for clarity per ECR-09-149	6/9/2009	JTW
C	Changed asterisk marking on first page so references to included vs non included parts are there PER ECR-11-305	9/21/2011	LSE
D	Revised to include 22CCT6 (STEAMCHEF 6) per ECO-002000	9/13/2019	FG
-	Added FA11384, FA31031, FA30506	8/12/2020	SZ