

| LET. | REVISIONS | DATE | BY |
|------|---------------------------------|----------|-----|
| A | CHANGED PIN 1436 FROM 1437 | 7-18-91 | SM |
| B | ADDED PIN 10482 | 4-08-92 | SM |
| C | REBRANN IN ACID, PER ECR-08-201 | 09-08-98 | TJW |

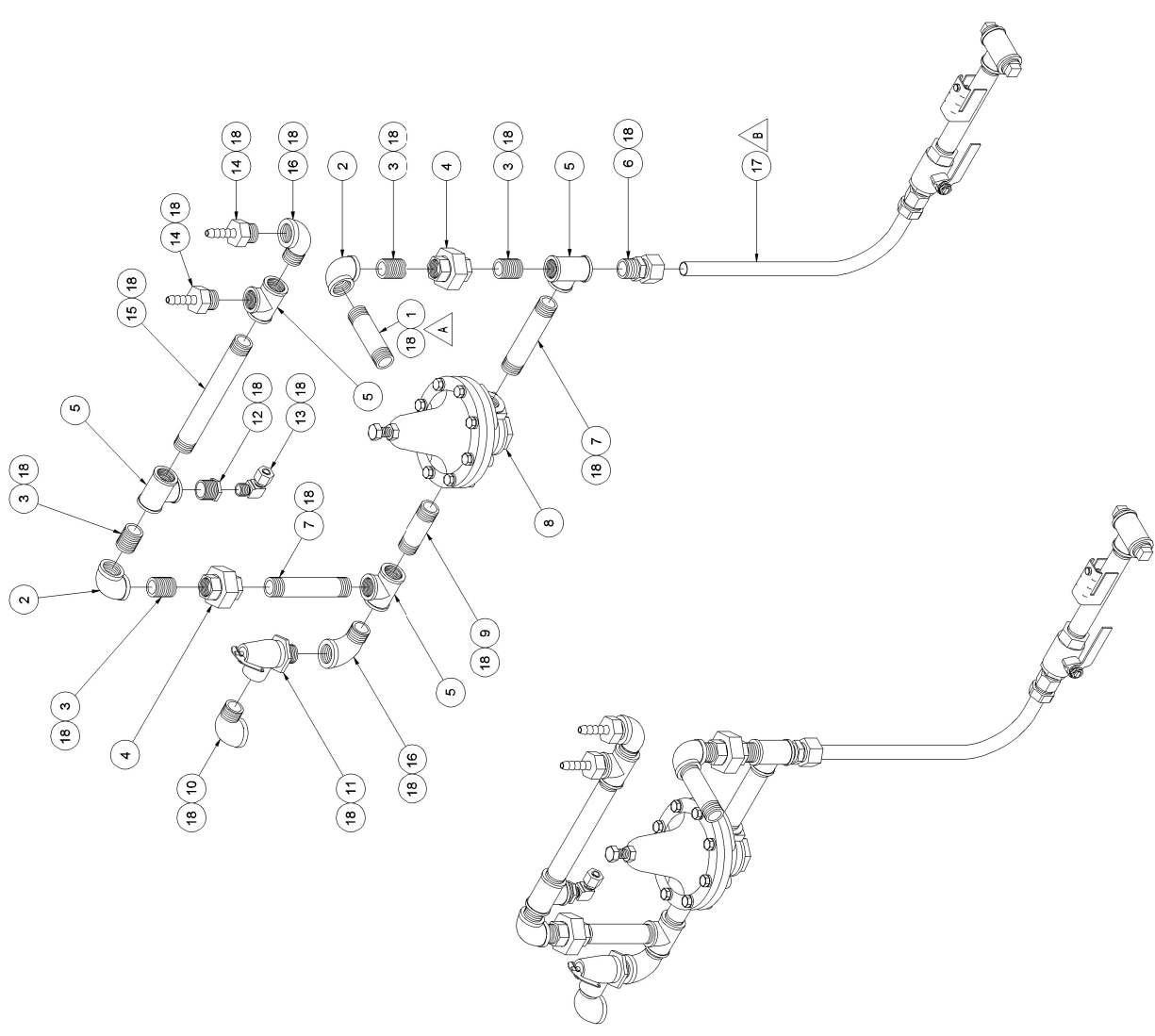

| ITEM | QTY | PART NO. | DESCRIPTION |
|------|-----|----------|--------------------------------------|
| 18 | AR | 06384 | SEALANT, RECTORSEAL |
| 17 | 1 | 10482 | PTO FOR 7" PRESSURE STEAMER |
| 16 | 2 | 06231 | ELBOW, STREET, 90°, 3/4" BRASS |
| 15 | 1 | 14486 | NIPPLE, 3/4" X 8" |
| 14 | 2 | 06235 | FITTING, HOSE BARB, 1/2" X 3/4" MPT |
| 13 | 1 | 06217 | FITTING, COMP, 3/8" X 3/8" MPT, 90° |
| 12 | 1 | 06575 | BUSHING, REDUCING, 3/4" X 3/8" BRASS |
| 11 | 1 | 22130 | VALVE, ROLLER SAFETY, 3/4", 8 PSI |
| 10 | 1 | 06259 | ELBOW, STREET, 90°, 3/4" BLACK |
| 9 | 1 | 14346 | NIPPLE, 3/4" X 2.5", BRASS |
| 8 | 1 | 22122 | VALVE, 3/4" PRESSURE REDUC., 3-1/2# |
| 7 | 2 | 14382 | NIPPLE, 3/4" X 4", BRASS |
| 6 | 1 | 06208 | FITTING, COMP, 3/4" X 3/4" MPT, ST. |
| 5 | 4 | 20206 | TEE, 3/4" BRASS |
| 4 | 2 | 21304 | UNION, 3/4" RED BRASS |
| 3 | 4 | 14342 | NIPPLE, 3/4" X CLOSE, RED BRASS |
| 2 | 2 | 06280 | ELBOW, 90°, 3/4" BRASS |
| 1 | 1 | 14348 | NIPPLE, 3/4" X 3", BRASS |

| | |
|---|---|
| CLEVELAND RANGE, LLC 1338 East 179th St., Cleveland, Ohio 44110-2874 | |
| <small>THIS DRAWING IS A PROPERTY OF CLEVELAND RANGE, LLC. IT IS TO BE USED ONLY FOR THE PROJECT AND QUANTITY SPECIFIED HEREON. IT IS NOT TO BE REPRODUCED OR TRANSMITTED IN ANY FORM OR BY ANY MEANS, ELECTRONIC OR MECHANICAL, INCLUDING PHOTOCOPYING, RECORDING, OR BY ANY INFORMATION STORAGE AND RETRIEVAL SYSTEM, WITHOUT THE WRITTEN PERMISSION OF CLEVELAND RANGE, LLC.</small> | |
| TOLERANCES UNLESS OTHERWISE NOTED | DRAWN BY S. MILEWSKI DATE 06-24-91 |
| TITLE | POWER TAKE-OFF ASSEMBLY (PTO) "2 1/2" PRESSURE STEAMER |
| DECIMAL | ±0.00 |
| ANGULAR | ±1° |
| SIZE | DRAWING NO. 104787 |
| REV | SHEET 1 OF 1 C |