

## MINI MVP TILT SKILLET EASYTOUCH

ELECTRIC TABLE TYPE, RECTANGULAR,  
10 GALLON (40 LITER) WORKING CAPACITY

Project \_\_\_\_\_  
Item \_\_\_\_\_  
Quantity \_\_\_\_\_  
FCSI Section 11400 \_\_\_\_\_  
Approved \_\_\_\_\_  
Date \_\_\_\_\_

### Models

- SET-10 easyTouch



Shown with easyTouch 7" Display Optional  
Double Pantry Faucet (DPK24)



Optional Sous-Vide Pump    Optional Sous-Vide & Frying Baskets

### Standard Features

- Heating Element are cast integrally into 1.25" (32mm) thick aluminum blocks which are securely camped to the underside of the cooking surface, providing even heat distribution and energy efficiency with rapid heat-up
- Stainless Steel Cooking Surface is structurally braced to prevent warping
- 12 gallon (45 liter) capacity to rim, 10 gallon (40 liter) working capacity
- Bead-blast Textured Cooking Surface Finish to reduce sticking
- Heavy Duty Stainless Steel Construction, with #4 Finish
- easyTouch 7" UI display Interface is conveniently located in a Drip Proof Side Console. Temperature controlled up to 425°F (220°C)
- Sanitary Base Mounting for Table Top or Stand Mounted Installation
- Standard 208 Volts, 60 Hz, 3 Phase, 3 Wire, Standard Wattage
- Spring Assist Cover & Soft Drop Pan Release
- Typical approvals include NSF, UL
- Meets IPX6 water rating guidelines for console
- Product Probe

### easyTouch 7" Control

- 7" easyTouch UI interface simplifies operations with accurate touch tune
- Multi-step cooking modes, including sous-vide & probe modes
- Press & Go Recipes with cookbook storage
- Self Diagnostics & Maintenance - error & event logs

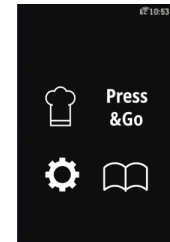

7" easyTouch Display

### Options & Accessories

- Sous-Vide Pump
- Sous-Vide & Frying Baskets
- Poaching Pans (PP)
- Vegetable Steamer (VS)
- Double or Single Water Faucet with Swing Spout (DPK24) or (SPK24)
- Stainless Steel Support Stands (ST28) with Sliding Drain Drawer and Splash Screen
- Single phase option (SPH)
- Food Strainer (SF10)
- 1.5" Tangent Draw-off (38mm) (TD1.5)
- 208 - 240 volt, 60 Hz., 1 or 3 phase in standard or high wattage (VOSK1)

### Short Form Specifications

Shall be CLEVELAND 10 Gallons (40 liters)  
Model SET-10 easyTouch \_\_\_\_\_; \_\_\_\_\_ KW  
\_\_\_\_\_ Volt, mini tilt skillet of type 304  
Stainless Steel Construction, with #4 Finish.  
Electric Heating Elements cast integrally onto  
1.25"/ 32mm thick aluminum blocks and  
securely clamped beneath cooking surface.  
Bead-Blast-Textured Cooking Surface.  
Complete with Thermostatic, Safety and Main  
Power Controls with Lighted Indicators. For  
Table Top Mounting. Spring Assist Cover.

KE004046-90

# Cleveland

## Braising Pans / Tilting Skillets

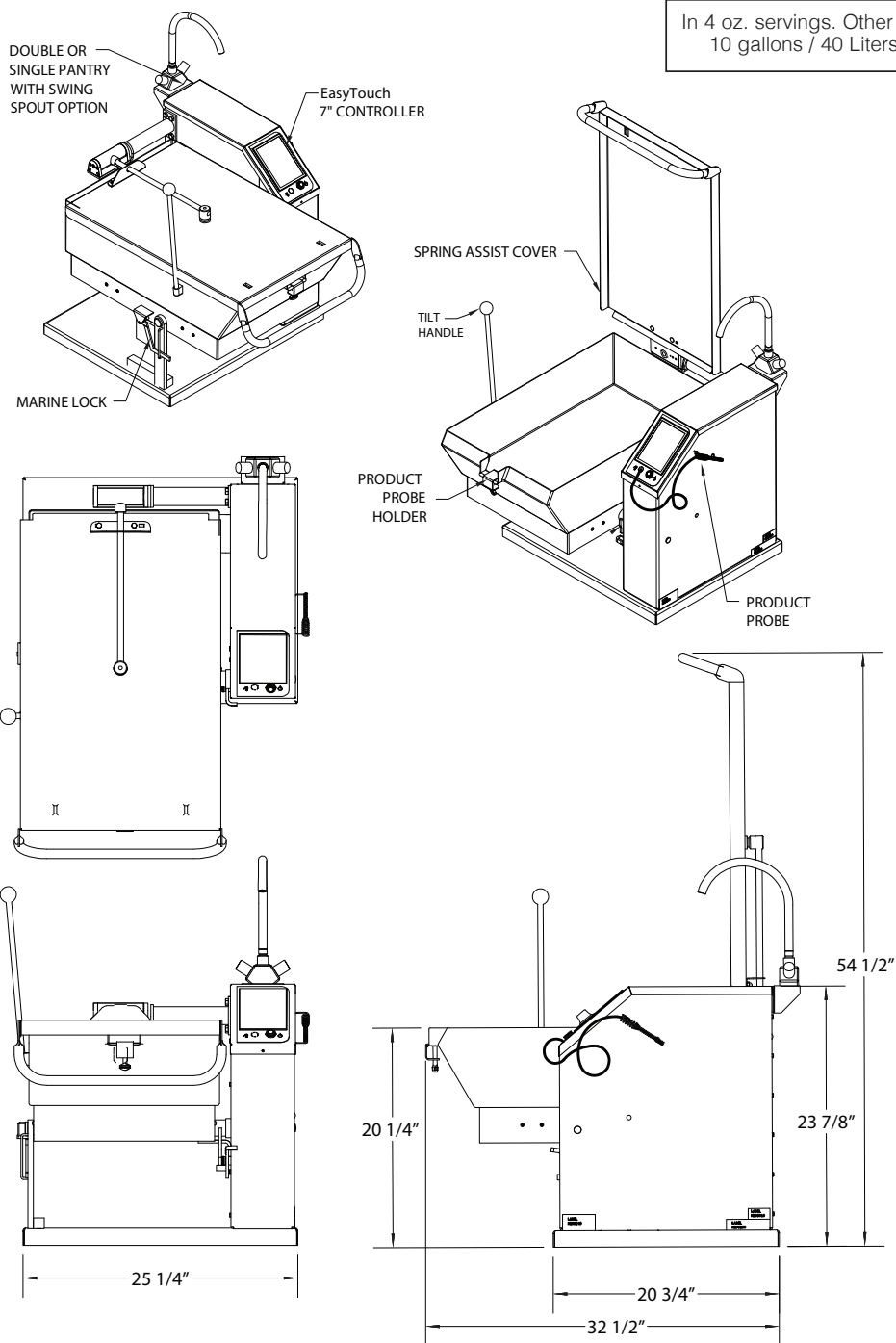

**CAPACITIES**

In 4 oz. servings. Other sizes may be calculated.  
 10 gallons / 40 Liters ..... 320

ELECTRIC ⚡										
GALS LITERS		208 VOLTS			240 VOLTS			220 /380 VOLTS		
		AMPS			AMPS			AMPS		
		1 PH	3 PH	KW	1 PH	3 PH	KW	1 PH	3 PH	KW
10	40	7.4	35.4	20.5	7.8	32.7	18.9	6.5	N/A	9.9

DUAL VOLTAGE OF 220/380 SHOWN ON CHART REQUIRES A FOUR WIRE, THREE PHASE ELECTRICAL SUPPLY.

CLEARANCE	
RIGHT	= 3.00"
LEFT	= 0"
REAR	= 1.00"

Shipping Weights & Dimensions	
Model - SET-10	Weight - 212 lbs
	Width - 26"
	Depth - 34"
	Height - 30.5"

**NOTES:**  
 Cleveland Range reserves right of design improvement or modification, as warranted.  
 Many regional, state and local codes exist and it is the responsibility of the owner and installer to comply with the codes.  
 Cleveland Range equipment is built to comply with applicable standards for manufacturers. Included among those approval agencies are U.L., NSF, CGA, CSA, ETL and others.

(NOT TO SCALE)